

ELECTRICAL LEGEND	
	INCAANDESCENT LIGHT FIXTURE (CEILING MOUNTED)
	INCAANDESCENT LIGHT FIXTURE (PULL CHAIN-LOCATION)
	INCAANDESCENT LIGHT FIXTURE (WALL MOUNTED)
	RECESSED LIGHT FIXTURE
	FLUORESCENT LIGHT FIXTURE
	DUPLEX CONVENIENCE OUTLET
	DUPLEX CONVENIENCE OUTLET (COUNTER HEIGHT)
	DUPLEX CONVENIENCE OUTLET (SPLIT WIRED)
	DUPLEX CONVENIENCE OUTLET (GROUND FAULT INTERRUPTER)
	DEDICATED LINE (GARAGE DOOR)
	DEDICATED LINE (MICROWAVE/MICROHOOD)
	DEDICATED LINE (RANGE)
	DEDICATED LINE (DRYER)
	DEDICATED LINE (REF./FREEZER)
	FAN/LIGHT COMBINATION
	FAN UNIT ONLY
	SINGLE POLE SWITCH
	THREE-WAY SWITCH
	FOUR-WAY SWITCH
	DIMMER SWITCH
	THERMOSTAT
	SMOKE DETECTOR
	DOOR BELL BUTTON
	DOOR BELL CHIMES
	PHONE JACK
	TV OUTLET
	ARC FAULT CIRCUIT INTERRUPTER REQUIRED ON ALL BEDROOM 120V BRANCH CIRCUITS
PLUMBING LEGEND	
	FROST PROOF HOSE BIB
	HOT WATER
	COLD WATER
	SANITARY DRAIN
NOTES:	
1) ALL ELECTRICAL CONSTRUCTION TO CONFORM TO THE NEC AND LOCAL RULES & REGULATIONS.	
2) ALL PLUMBING CONSTRUCTION TO CONFORM TO THE IRC PLUMBING REQUIREMENTS.	
SERVICES TO HOUSE	
WATER	-3/4"
SANITARY SEWER	-4"
SINK	
COLD WATER	-1/2"
HOT WATER	-1/2"
SANITARY DRAIN	-1 1/2"
TUB/SHOWER	
COLD WATER	-1/2"
HOT WATER	-1/2"
SANITARY DRAIN	-1 1/2"
WASHING MACHINE	
COLD WATER	-1/2"
HOT WATER	-1/2"
SANITARY DRAIN	-2"
WATER HEATER	
COLD WATER	-3/4"
HOT WATER	-3/4"
LAVATORY	
COLD WATER	-1/2"
HOT WATER	-1/2"
SANITARY DRAIN	-1 1/4"
WATER CLOSET	
COLD WATER	-1/2"
SANITARY DRAIN	-3"
HOSE BIBS	
COLD WATER	-1/2"
FLOOR DRAIN	
SANITARY DRAIN	-2"

NOTE: DRYER VENT LENGTH NOT TO EXCEED 25'.
 SUBTRACT 5' FOR EACH 90 DEG. ELBOW. &
 2 1/2' FOR EACH 45 DEG. ELBOW. LENGTH
 OF DUCT MAY EXCEED 25' ONLY IF
 MANUFACTURER SPECIFICATIONS ALLOW
 AND ARE ON SITE AT TIME OF INSPECTION.

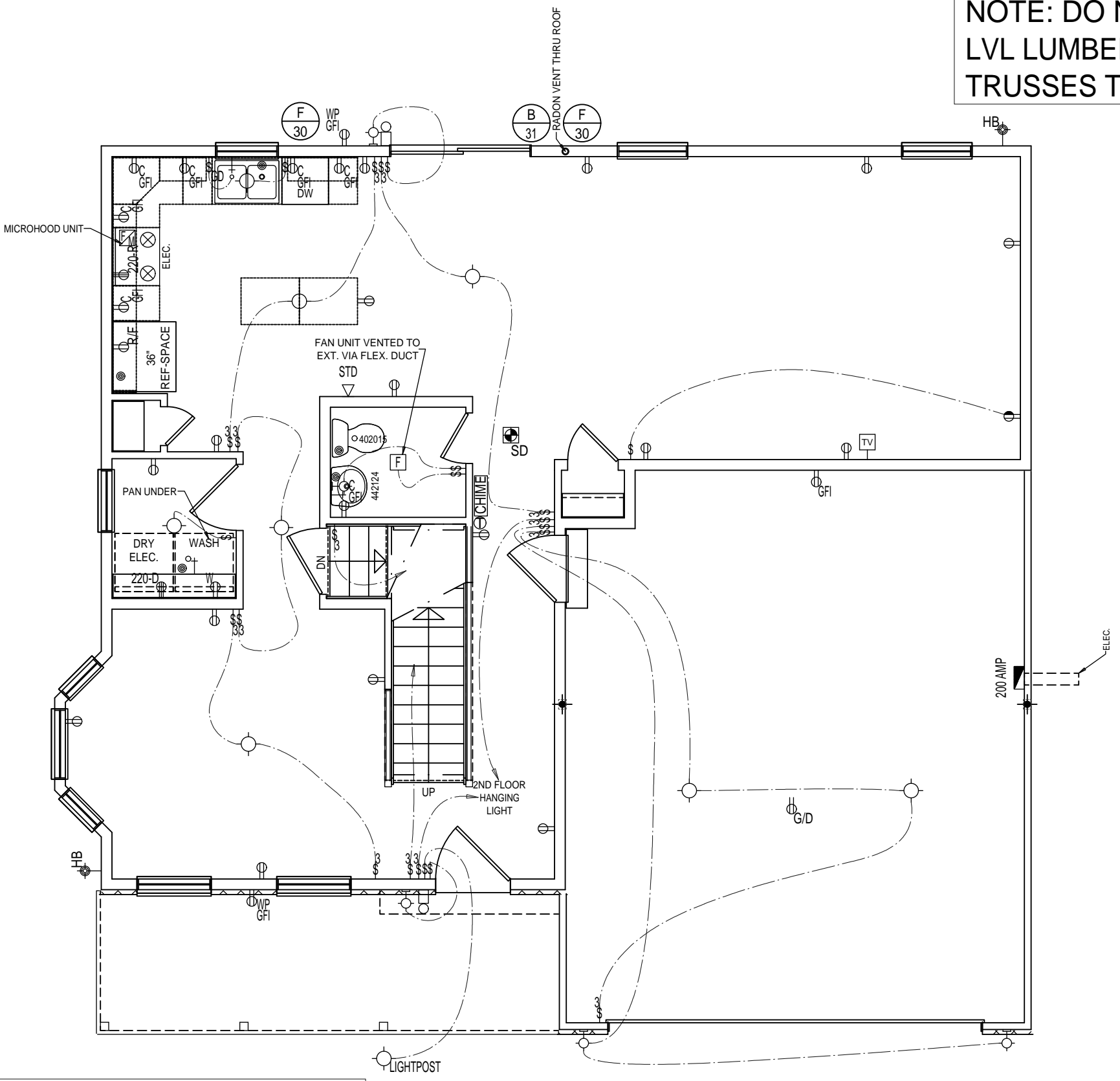

FIRST FLOOR MECHANICAL LAYOUT
 SCALE: 3/16" = 1'-0"

NOTE: DO NOT DRILL OR CUT ANY
 LVL LUMBER AND/OR ENGINEERED
 TRUSSES TO INSTALL MECHANICALS

MECHANICAL NOTES:

- EXTERIOR HOSE BIBS TO BE PROTECTED BY ANTI-SIPHON DEVICE OR CHECK VALVE.
- SMOKE DETECTORS TO BE INTERCONNECTED.
- THESE MECHANICAL DRAWINGS ARE DIAGRAMMATIC. ABSOLUTE ACCURACY IS NOT WARRANTED. THE EXACT LOCATION, DISTANCES AND AMOUNT WILL BE GOVERNED BY ACTUAL CONSTRUCTION AND THE DRAWINGS SHOULD ONLY BE USED FOR GUIDANCE IN SUCH REGARD.
- HOMEOWNER NEEDS, OPERATING EFFICIENCY, CONSTRUCTION AND CODE REQUIREMENTS ARE THE BASIS FOR SELECTING MECHANICAL EQUIPMENT.
- LOCATIONS. DO NOT CHANGE WITHOUT PRIOR APPROVAL FROM AN AUTHORIZED SAA REPRESENTATIVE.
- DO NOT DRILL OR CUT ANY LVL LUMBER AND/OR ENGINEERED TRUSSES TO INSTALL MECHANICALS.
- LOCATE ALL TV AND PHONE JACKS PRIOR TO START OF CONSTRUCTION.
- DO NOT DRILL HOLES IN THE TOP & BOTTOM 2" OF FLOOR JOISTS. DIAMETER SHALL NOT EXCEED 1/3 THE DEPTH OF THE JOIST.

REMARKS	
DATE	DRAWN BY
BENTRIDGE 498AR	
SAA HOMES	
A RESIDENCE FOR: MOUNTAIN SHADOWS 29D	
CUSTOMER SIGNATURE #1:	CUSTOMER SIGNATURE #2:
SALESPERSON SIGNATURE #1: 04/20/07	SALESPERSON SIGNATURE #2:
PAGE NO. M-1	
JOB NUMBER 13 70157	
TRUELINE NUMBER 137129	

ORIGINAL DESIGN BY FRANK BETZ ASSOCIATES
 COPYWRITE 2002 BY FRANK BETZ ASSOCIATES, INC.

PRECON PLANS

ELECTRICAL LEGEND

	INCAANDESCENT LIGHT FIXTURE (CEILING MOUNTED)
	INCAANDESCENT LIGHT FIXTURE (PULL CHAIN-LOCATION)
	INCAANDESCENT LIGHT FIXTURE (WALL MOUNTED)
	RECESSED LIGHT FIXTURE
	FLUORESCENT LIGHT FIXTURE
	DUPLEX CONVENIENCE OUTLET
	DUPLEX CONVENIENCE OUTLET (COUNTER HEIGHT)
	DUPLEX CONVENIENCE OUTLET (SPLIT WIRED)
	DUPLEX CONVENIENCE OUTLET (GROUND FAULT INTERRUPTER)
	DEDICATED LINE
	DEDICATED LINE (GARAGE DOOR)
	DEDICATED LINE (MICROWAVE/MICROHOOD)
	DEDICATED LINE (RANGE)
	DEDICATED LINE (DRYER)
	DEDICATED LINE (REF./FREEZER)
	FAN/LIGHT COMBINATION
	FAN UNIT ONLY
	SINGLE POLE SWITCH
	THREE-WAY SWITCH
	FOUR-WAY SWITCH
	DIMMER SWITCH
	THERMOSTAT
	SMOKE DETECTOR
	DOOR BELL BUTTON

	DOOR BELL CHIMES
	PHONE JACK
	TV OUTLET
	ARC FAULT CIRCUIT INTERRUPTER REQUIRED ON ALL BEDROOM 120V BRANCH CIRCUITS

PLUMBING LEGEND

	FROST PROOF HOSE BIB
	HOT WATER
	COLD WATER
	SANITARY DRAIN

NOTES:

- 1) ALL ELECTRICAL CONSTRUCTION TO CONFORM TO THE NEC AND LOCAL RULES & REGULATIONS.
- 2) ALL PLUMBING CONSTRUCTION TO CONFORM TO THE IRC PLUMBING REQUIREMENTS.

SERVICES TO HOUSE

WATER	-3/4"
SANITARY SEWER	-4"

SINK

COLD WATER	-1/2"
HOT WATER	-1/2"
SANITARY DRAIN	-1 1/2"

TUB/SHOWER

COLD WATER	-1/2"
HOT WATER	-1/2"
SANITARY DRAIN	-1 1/2"

WASHING MACHINE

COLD WATER	-1/2"
HOT WATER	-1/2"
SANITARY DRAIN	-2"

WATER HEATER

COLD WATER	-3/4"
HOT WATER	-3/4"

LAVATORY

COLD WATER	-1/2"
HOT WATER	-1/2"
SANITARY DRAIN	-1 1/4"

WATER CLOSET

COLD WATER	-1/2"
SANITARY DRAIN	-3"

HOSE BIBS

COLD WATER	-1/2"
------------	-------

FLOOR DRAIN

SANITARY DRAIN	-2"
----------------	-----

NOTE: DO NOT DRILL OR CUT ANY LVL LUMBER AND/OR ENGINEERED TRUSSES TO INSTALL MECHANICALS

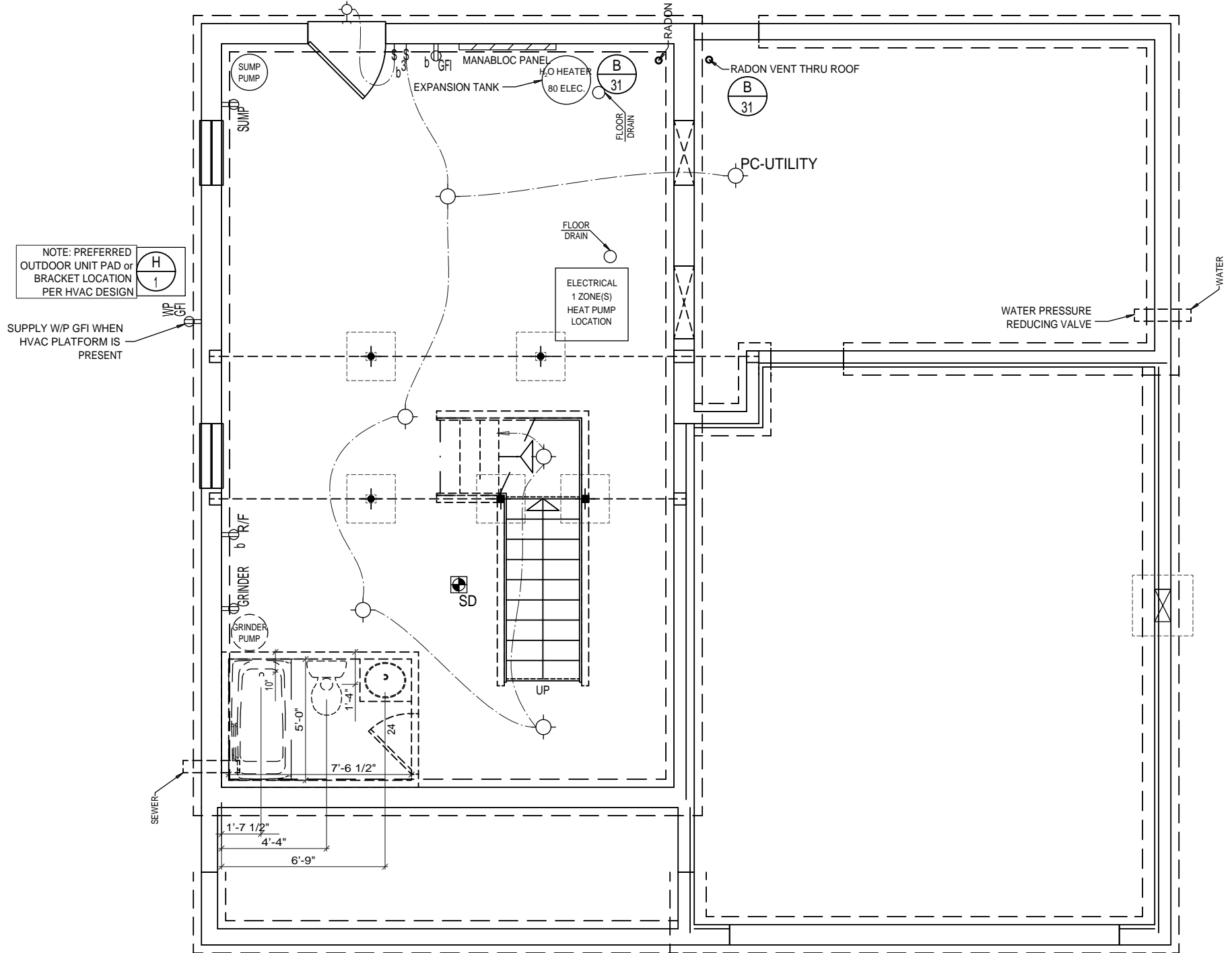

BASEMENT MECHANICAL LAYOUT
SCALE: 3/16" = 1'-0"

ORIGINAL DESIGN BY FRANK BETZ ASSOCIATES
COPYWRITE 2002 BY FRANK BETZ ASSOCIATES, INC.

PRECON PLANS

REMARKS	
DATE	
DRAWN BY	

BENTRIDGE
498AR

A RESIDENCE FOR:
MOUNTAIN SHADOWS 29D

DRAWN BY: CMW
CUSTOMER SIGNATURE #1: [Signature Line]
CUSTOMER SIGNATURE #2: [Signature Line]

PLAN STARTED: 04/20/07
SALESPERSON SIGNATURE #1: [Signature Line]
SALESPERSON SIGNATURE #2: [Signature Line]

PAGE NO.
M-3

JOB NUMBER
13 70157

TRUELINE NUMBER
137129

