

FLASHING NOTE:  
 S.G. TO PROVIDE FLASHING & GOUNTER FLASHING PER SMAGNA STANDARDS AT ALL INTERSECTING VERTICAL SURFACES.

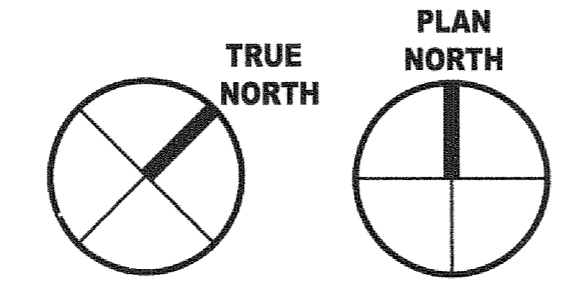

**1** **ROOF PLAN**  
 SCALE: 3/16" = 1'-0"

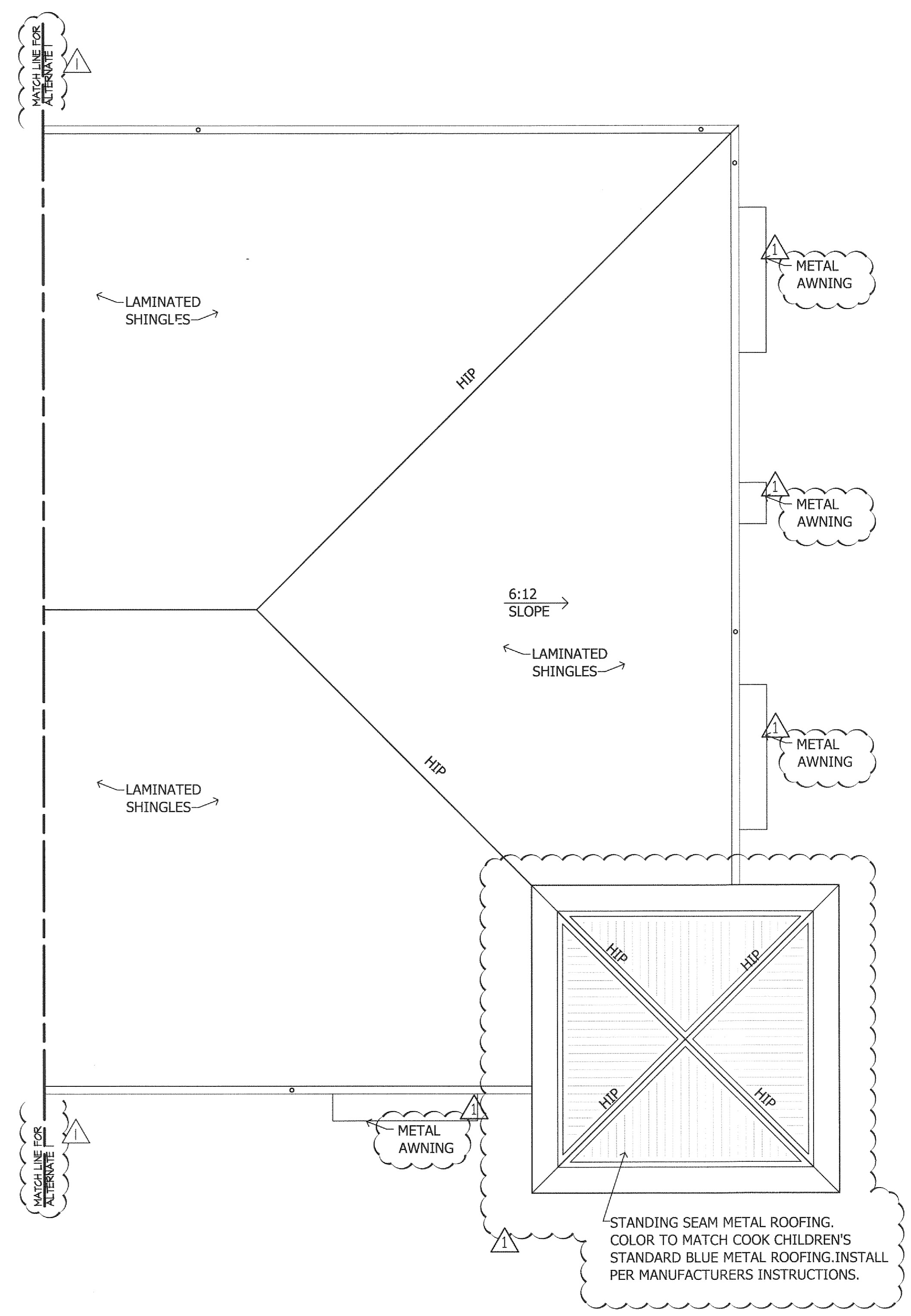

**1** **ALTERNATE 1 ROOF PLAN**  
 SCALE: 3/16" = 1'-0"

OWNER REVISIONS  
 04-30-04  
 CONTRACTOR SHALL VERIFY ALL DIMENSIONS AT THE JOB SITE AND NOTIFY THE ARCHITECTS OF ANY DIMENSIONAL ERRORS, OMISSIONS OR DISCREPANCIES BEFORE BEGINNING OR FABRICATING ANY WORK  
 DO NOT SCALE DRAWINGS

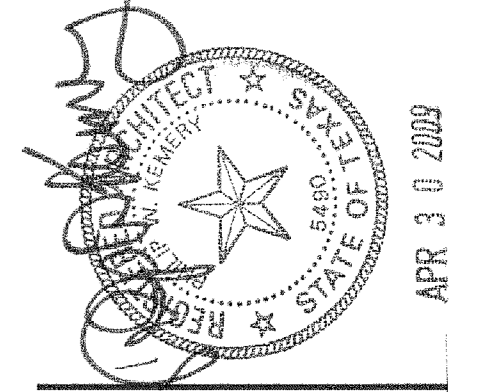

**Linear!**  
 the architecture of Kemery Brundige and Young  
 8600 Freepoint pkwy. Ste. 310  
 Irving, TX 75063  
 Phone: 972.929.9226  
 Fax: 972.929.9061  
 info@linear-architecture.com

**COOK CHILDREN'S  
 PRIMARY CARE CLINIC**  
 BURLESON, TX

JOB NUMBER  
**09.016**

SHEET TITLE  
**ROOF PLAN**

SHEET NUMBER  
**A2.2**

DATE OF ORIGINAL ISSUE  
 © MARCH 16, 2009