

NOTE: PLEASE REFER TO GENERAL NOTE 15 ON THE COVERSHEET FOR DIMENSION INFORMATION

NOTE: PLEASE REFER SHEET A4.1 FOR DOOR AND WINDOW SCHEDULES.

TV NOTE:
G.C. TO VERIFY TYPE AND LOCATION OF OWNER SUPPLIED T.V.'S WITH OWNER AND INSTALL APPROPRIATE BLOCKING AND MOUNTING HARDWARE. THE LOWEST PORTION OF THE T.V. SHALL NOT BE LOWER THAN 80" AFF PER CHAPTER 10 VOL-1-C

CORNER NOTE:
CORNER MOLDING EQUAL TO IPC - 160 EN SHALL BE INSTALLED ON ALL OUTSIDE CORNERS THROUGHOUT CLINIC, 4" HIGH

SHELVING NOTE:
PROVIDE (5) 18" DEEP 1" THICK ADJUSTABLE LAMINATE SHELVES, EVENLY SPACED.

WALL TYPE LEGEND

	EXTERIOR WALLS - 2X6 MD STUDS, FINISH AS INDICATED ON ELEVATIONS
	NEW FULL HT INTERIOR PARTITION, WALL TYPE A ON SHEET A4.1 U.N.O.
	NEW 5'-0" INTERIOR PARTITION, WALL TYPE B ON SHEET A4.1 U.N.O.
	NEW DEMISING WALL, WALL TYPE C ON SHEET A4.1 U.N.O.

NOTE: GC TO INSTALL SOUND INSULATION ON EXAM, BATHROOM, & CORRIDOR WALLS

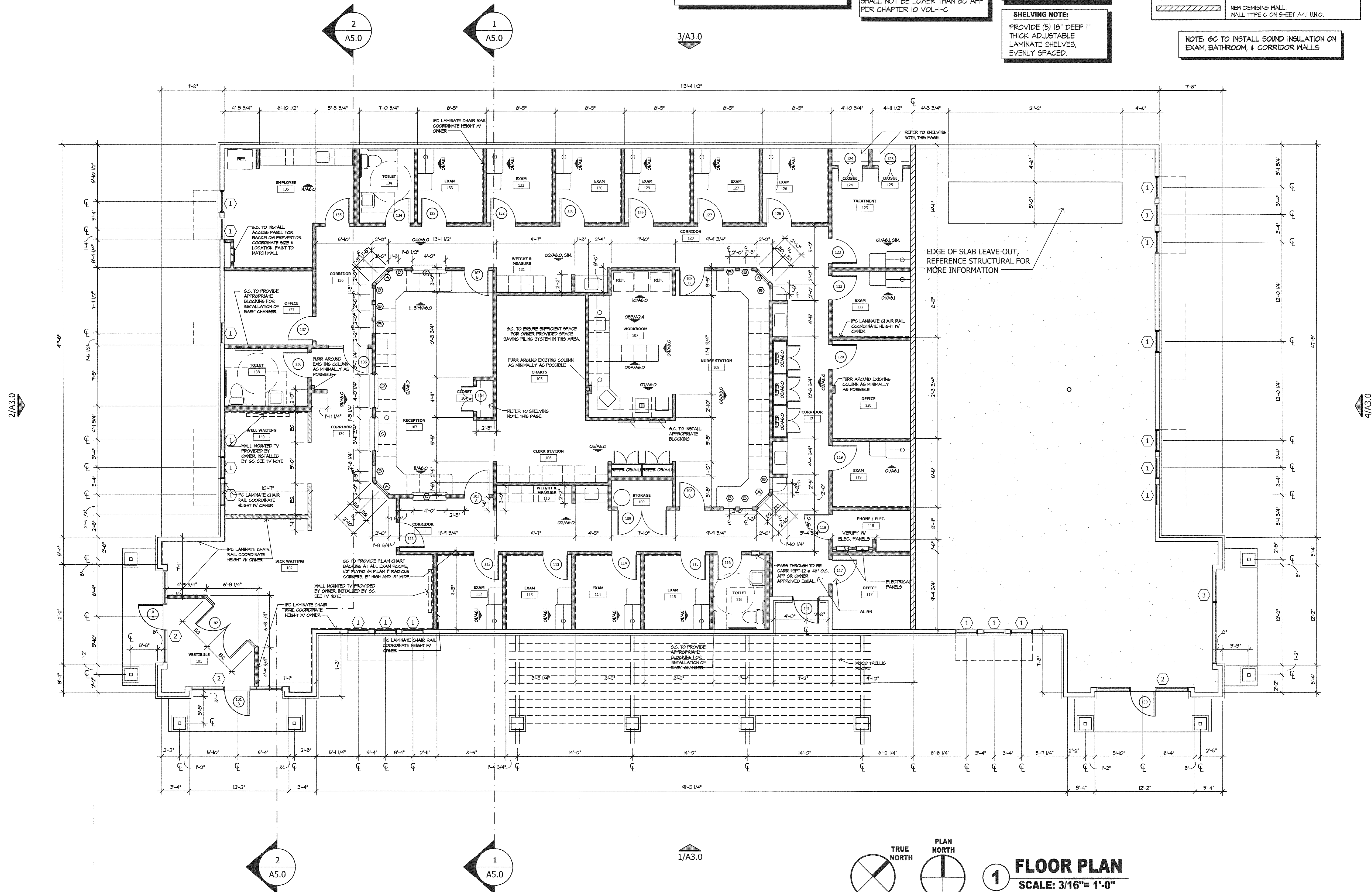

CONTRACTOR SHALL VERIFY ALL DIMENSIONS AT THE JOB SITE AND NOTIFY THE ARCHITECTS OF ANY DIMENSIONAL ERRORS, OMISSIONS OR DISCREPANCIES BEFORE BEGINNING OR FABRICATING ANY WORK. DO NOT SCALE DRAWINGS.

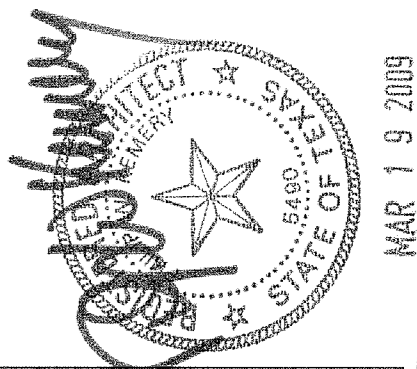

Linear!
the architecture of Kerymy Brundage and Young
8608 Freepoint pkwy, Ste. 310
Irving, TX 75063
Phone: 972.929.9226
Fax: 972.929.9061
inbox@linear-architecture.com

**COOK CHILDREN'S
PRIMARY CARE CLINIC**
BURLESON, TX

JOB NUMBER
09.016

SHEET TITLE
FLOOR PLAN

SHEET NUMBER
A2.0

DATE OF ORIGINAL ISSUE
MARCH 16, 2009

REVISIONS
DATE

1/A3.0

4/A3.0

2/A3.0

1 FLOOR PLAN
SCALE: 3/16" = 1'-0"

