

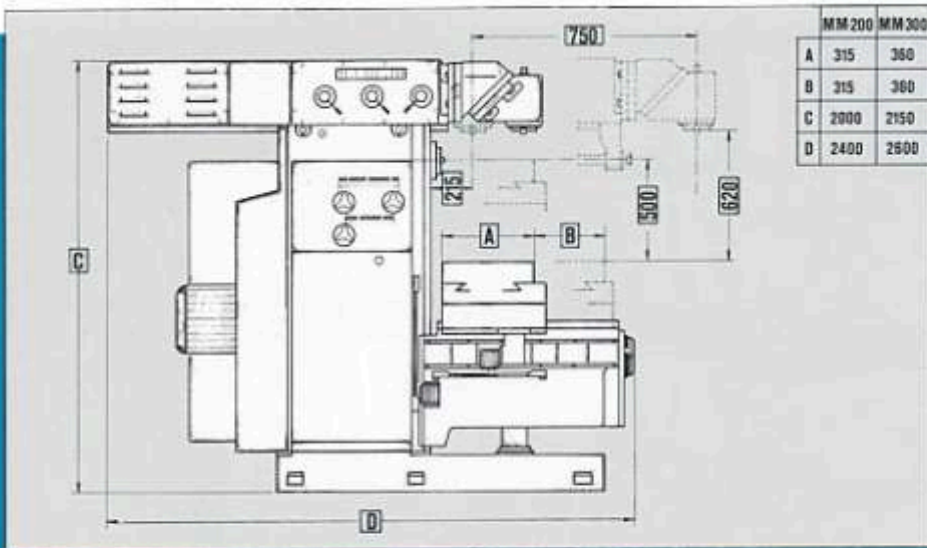

MM



INDUMA gse S.r.l. - Via Salvo D'Acquisto, 49 - 20049 Concorezzo (MI) Italy
Tel. ++39 039.648.518 - Fax ++39 039.60.49.118 - www.induma.it - www.induma.net - E-mail: info@induma.it



MOTORIZED OVERARM		SMB 8
Taper	ISO	50
Spindle speed range	r.p.m.	40-1500
Spindle speed selection	N.	12
Motor	HP	7,5
Overarm manual travel	mm	750
Weight	Kg	650

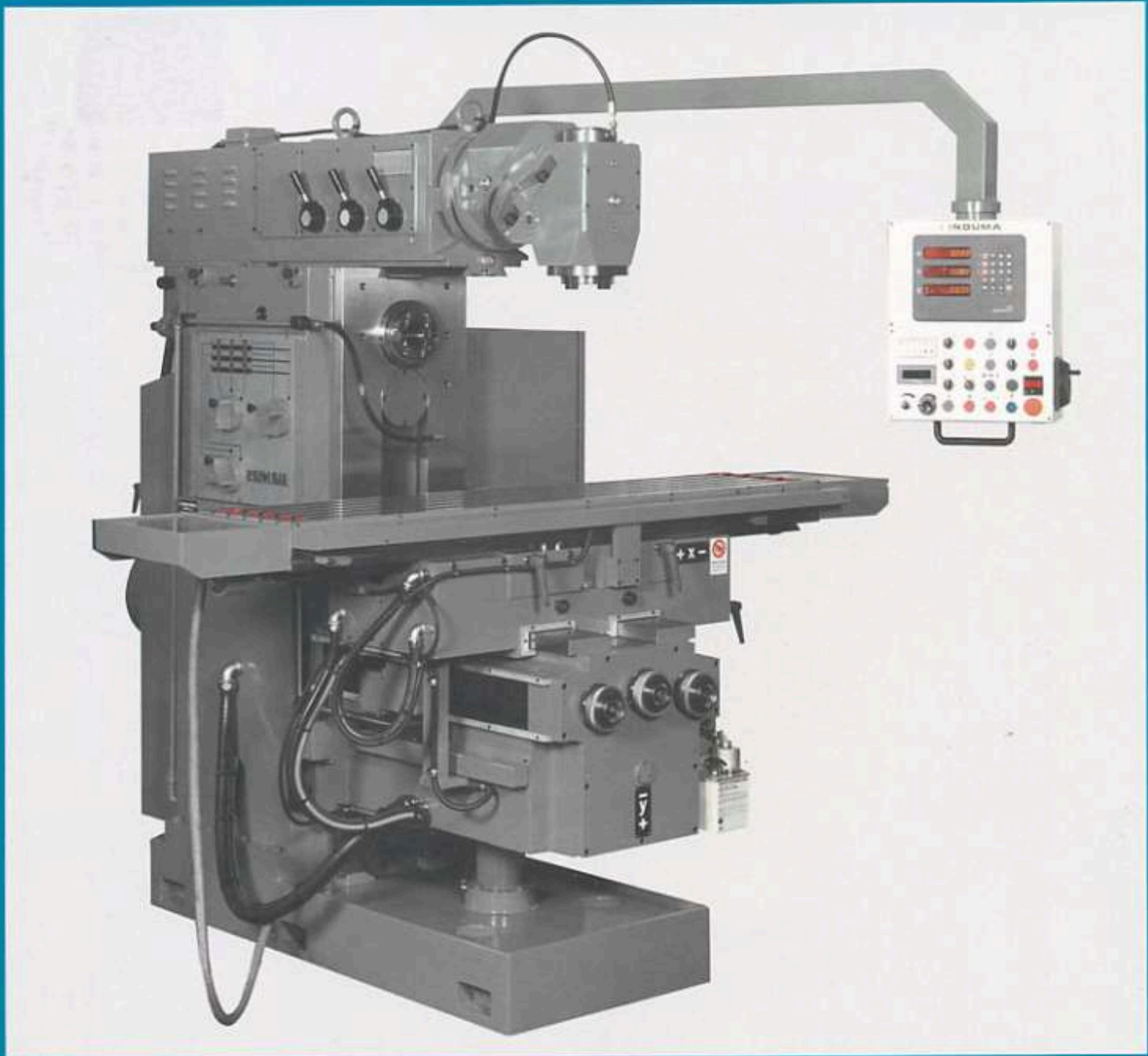

MM SM



INDUMA gse S.r.l. - Via Salvo D'Acquisto, 49 - 20049 Concorezzo (MI) Italy
 Tel. + +39 039.648.518 - Fax + +39 039.60.49.118 - www.induma.it - www.induma.net - E-mail: info@induma.it

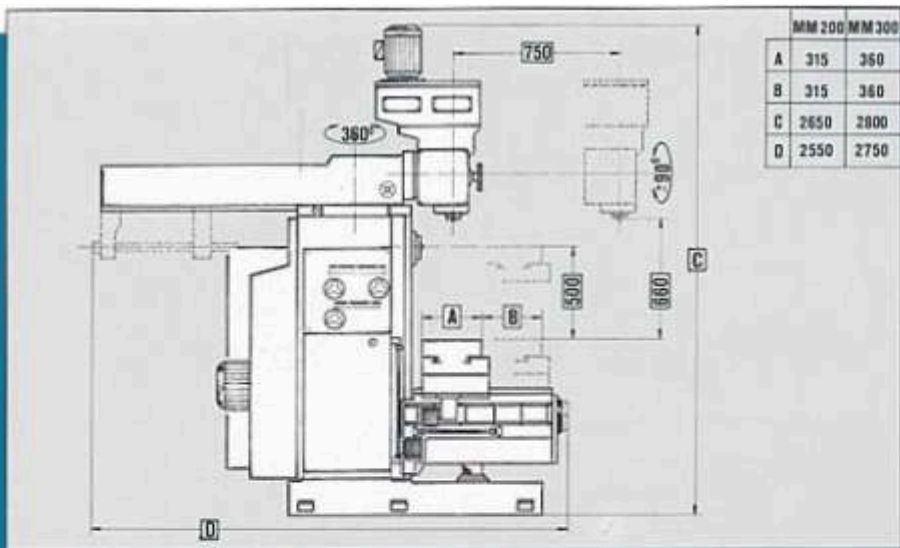

SENSITIVE HEAD		3S	4S	8S
Taper	ISO	40	40	40
Quill diameter	mm	95	100	120
Quill travel	mm	130	130	140
Spindle speed with stepless variator	r.p.m.	70	70	70
N. 3 autom. feeds	mm/r.	0,05 - 0,10 - 0,15		
Overarm manual travel	mm	750		
Motor	HP	2,5/3,5	3,5/4,5	6/7,5
Weight	Kg	180	220	320



MM TS



INDUMA gse S.r.l. - Via Salvo D'Acquisto, 49 - 20049 Concorezzo (MI) Italy
Tel. + +39 039.648.518 - Fax + +39 039.60.49.118 - www.induma.it - www.induma.net - E-mail: info@induma.it

	A	B	C	D	E
MM 200	315	315	1800	370	2400
MM 300	360	360	1950	410	2600

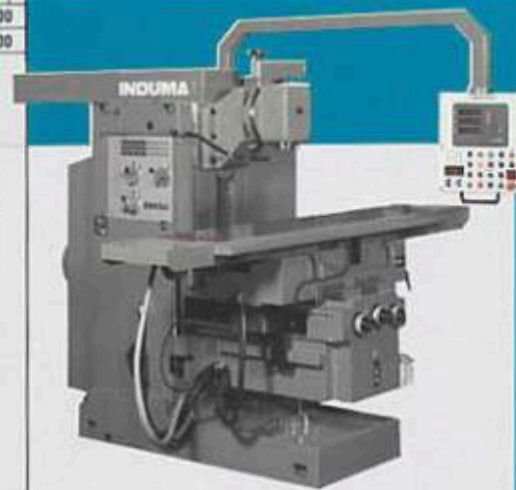
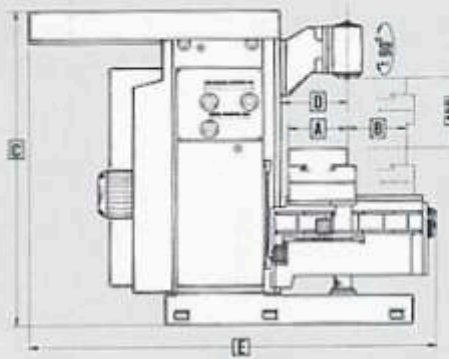
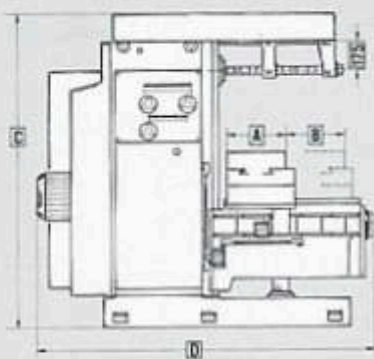

UNIVERSAL MILLING MACHINES

TECHNICAL DATA

SERIE

MM 200

MM 300

Table	Working surface	mm	1500x315	1700x360
	"T" slot N., width, distance		5x18x56	5x18x63
	Swivel	±	45°	45°
Travels	Longitudinal	mm	1100	1250
	Cross	mm	315	360
	Vertical	mm	500	500
Feeds	Working (longitudinal and cross)	mm/min.	0-2000	0-2000
	Working (vertical)	mm/min.	0-1000	0-1000
	Rapid (longitudinal and cross)	mm/min.	3000	3000
	Rapid (vertical)	mm/min.	1500	1500
Spindle	Taper	ISO	50	50
	Speed range	r.p.m.	31-1600	31-1600
	Speed selection	N.	18	18
Motors	Spindle	HP	10	15
	D.C. feeds	Nm	10	15
	Coolant pump	HP	0,25	0,25
Weight	Net	Kg	2.600	3.200
Dimensions	Length x Width x Height	m	2,2 x 2 x 2	2,4 x 2,2 x 2,2

STANDARD TECHNICAL FEATURES

- Axes feed selection by D.C. motor and three electromagnetic clutches
- Main spindle box provided with 18 speeds selection, hardened and ground gears, electromagnetic clutch and brake
- Hardened and ground slideways on the knee and column
- Screws and slideways provided with backlash eliminator system
- Centralized lubrication
- Coolant system
- Electronic handwheel for manual control of the three axes

OPTIONALS

- Hydraulic quick tool clamping
- Hydraulic automatic lockings on the 3 axes
- Automatic lubrication
- Digital read-outs
- Paraxial positioning device
- CNC on the three axes
- Universal dividing-heads, rotary tables, milling arbors, collet chucks, collets, stub arbors, various reducers

ACCESSORIES

SLOTING HEAD



Travel mm 110
Swivel ± 90°
Spindle-Table distance mm 270

BIROTATIVE HEAD



Taper ISO 50
Spindle-Column distance mm 410
Spindle-Table distance mm 325

UNIVERSAL HEAD



Taper ISO 50
Spindle-Column distance mm 370
Spindle-Table distance mm 430

VERTICAL HEAD



Taper ISO 50
Swivel ± 90°
Spindle-Table distance mm 430

Technical data, descriptions and figures shown are only indicative and can be changed for technical improvements.