

LOBO AUSTRALIAN SHEPHERD ASSOCIATION'S
SEVENTH ANNUAL THREE PINE RANCH CLASSIC
AUGUST 16, 17, 18, & 19, 2007 (Thursday thru Sunday)

This is an ASCA sanctioned stockdog trial. All ASCA rules are applicable and will be enforced. Order rulebooks by calling ASCA at 979/778-1082 or downloading rulebooks at the ASCA website. Entry forms for the Classic, Tracking Forms for Other Breed Registrations, & Rulebooks are available online at <http://www.asca.org/Forms+and+Rule+Books>. If receiving this via USPS mail, an entry form and tracking form are attached.

ENTRIES OPEN: 6/1/07 PRE ENTRIES CLOSE: 8/10/07 Day-of Entry fees applicable 8/11/07 & forward. [NO REFUNDS after 7/10/07.](#)

TRIAL DAYS: STOCK CLASS OR STOCKDOG SUBSTITUTIONS OR CHANGES ARE TAKEN ONLY DURING STOCK TRIAL REGISTRATION TIMES

Substitutions allowed. When the stock runs are full, a waiting list will be taken and runs sold to those on the waiting list in order of receipt of entry and also notification date for sale of run. No entries will be accepted via mail postmarked prior to 6/1/07. No hand delivery stock entries will be accepted prior to 8/11/07. **ALL PRE-ENTRY STOCK entries MUST HAVE a POSTMARK!!** No facsimile or phone entries will be accepted. No entry will be accepted without a correctly completed & signed ASCA entry blank and remittance of full entry fee; **checks are deposited weekly.**

Insufficient funds will result in a \$25.00 fee. Folks who stop payment will be placed on a cash-only basis with Lobo. You will have five days to make good any insufficient funds with a money order, cashier's check or cash. Failure to make good on insufficient funds will result in your entry being marked invalid and all awards, legs, titles earned at this trial being withheld. You will then be put on a cash-only basis with the Lobo club.

MAIL YOUR STOCK ENTRIES TO: ANNE SHOPE, Entry Clerk, 671 Langley Road (AO-32), Estancia, NM 87016-8032

QUESTIONS: Call 505/384-2547(Arne Shope) or 505/286-4595(Diana Decker) Co-Course Directors. **[INCLUDE THE RECAP SHEET, PLEASE.](#)**

⇒The Show Secretary, Show/Trial Committee, Members of LASA, and the owners of the host facility assume no responsibility for any loss, damage or injury sustained by any exhibitor, handler, dog, property, child or spectator. This show & trial are being held on private property. You understand by your attendance and/or entry that the Show/Trial Committee and Hosts have the right to refuse or excuse any entry for good cause. Good cause would be violation of the private property owners' rights or violation of the ASCA show rules.

⇒Terrain at the host facility can be uneven; wear appropriate shoes. Elevation at the show site is approximately 6, 600'. Bring sunscreen. Nights can be cold!

⇒**Conformation & obedience (Saturday) are on a (tar) tennis court and your host club for these is ASANM** (contact info on last page of this flyer). The court is wet down when it gets hot. Wear appropriate shoes in which to compete. There is some shade on the court for both rings. The tennis court is OFF LIMIT during non-show hours to both spectators and dogs! Stay back 15' from the obedience ring during obedience competition. Be courteous to those trialing on stock by waiting to enter the pasture parking area until their run is complete. Be courteous to the obedience competitors when they are in the ring, please. NO GENERATORS may run during obedience or during the duck trialing. The Tennis Court will be roped off when not in use. **Thursday, Friday, & Saturday: STAY OFF the tennis court & out of the obedience ring unless competing in the ring.**

⇒**Remind** children to stay back from the arenas and show rings, away from crates and x-pens and to ALWAYS ask before running up to or petting a dog or puppy. **No children should be up at the main house.** PLEASE, no screaming, hollering or running children by arenas or rings during competition hours!

⇒When not in the arena or ring, ALL dogs must be either crated, in escape proof x-pens, or on lead and under control at all times. Protect your dog from fleas, ticks and the heat. The host facility does have snakes (kill rattlers, not our bullsnakes). Talk to the host if you are overly concerned about the snakes.

Co Course Directors: Diana Decker wyndblwn1@msn.com & Anne Shope legendsranch@hotmail.com

SPECIAL AWARD &/OR ROSETTE RULES AND REGULATIONS

MOST PROMISING STARTED AUSSIE

Aussies must be entered in the started classes only. The Aussie with the highest accumulated qualifying leg totals from the Friday, Saturday and Sunday stockdog trials will be awarded the Most Promising Aussie Special Award plus presented with a rosette. In addition, there will be a Most Promising Started Aussie award and rosette given for each trial.

MOST PROMISING STARTED OTHER BREED

Other Breeds must be entered in the started classes only. The Other Breed with the highest accumulated qualifying leg totals from the Friday, Saturday and Sunday stockdog trials will be awarded the Most Promising Other Breed Special Award plus presented with a rosette. In addition, there will be a Most Promising Started Other Breed award and rosette given for each trial.

HIGH COMBINED AUSSIE

Aussies must be entered in open or advanced classes only. The Aussie with the highest accumulated qualifying leg totals from the Friday, Saturday and Sunday stockdog trials will be awarded the High Combined Aussie Special Award and presented with a rosette. In addition, there will be a High Combined Aussie award and rosette given for each trial.

HIGH COMBINED OTHER BREED

Other Breeds must be entered in open or advanced classes only. The other breed with the highest accumulated qualifying leg totals from the Friday, Saturday and Sunday stockdog trials will be awarded the High Combined Other Breed Special Award and presented with a rosette. In addition, there will be a High Combined Other Breed award and rosette given for each trial.

HIGH IN TRIAL OVERALL

The Aussie or Other Breed who earns the overall highest score out of all classes of stock at each trial will be given an award and a rosette.

HIGH COMBINED CHAMPION OF RECORD (MARK ON YOUR ENTRY, PLEASE, IF YOUR DOG IS A BREED CHAMPION)

The ASCA Breed Champion Aussie who earns the highest combined qualifying scores at each trial will be presented with a rosette.

HIGH COMBINED OPEN – AUSSIE or OTHER BREED

The Aussie or Other Breed who earn the highest combined qualifying open scores at each trial will be presented with a rosette.

MOST VERSATILE AUSTRALIAN SHEPHERD

MVA is offered ONLY on Saturday. Aussies must be entered in: at least one class of stock, obedience, and one of the two conformation shows (both may be entered to up the chance of earning points). The highest qualifying stock score from the a.m/p.m. trial will be used and then 5 pts added for every additional qualifying stock score. The highest qualifying obedience score will be used with 5 pts added for any additional obedience score. In conformation: 1st place/5 pts, 2nd place/4 pts, 3rd place/3 pts and 4th place 2 pts., Winners/10 pts, Reserve Winners/7 pts, BOB or BOS 15 pts, premier 10 pts. All points accrued will be added together to determine the winner. A prize and rosette will be given to the winning MVA team. **Conformation/Obedience offered by ASANM (see last pg. of flyer)**

ALSO

Rosettes 1-4th place in all classes of stock. HIT in the post advanced & ranch trial each awarded prize and rosette Award & Rosette to 1st place in sheep & cattle in each of these trials. Other awards in the Classic may be given as the club desires.

REGISTRATION (LOCATED BY THE DUCK ARENA) IS 30 MINUTES PRIOR TO EACH HANDLER'S MEETING

Thursday RANCH TRIAL: Handler's meeting 7:30 a.m. – JUDGE ROY SAGE (all)

Cattle Ranch Trial begins 8:00 a.m. – 7 RUN LIMIT

Sheep Ranch Trial begins 30 minutes after Cattle Ranch Trial ends – 12 RUN LIMIT

Thursday POST ADVANCED TRIAL: Handler's meeting 1:00 p.m. – JUDGE ROY SAGE (all)

Cattle Post Advanced begins 1:30 p.m. – 6 RUN LIMIT

Sheep Post Advanced begins 30 minutes after Cattle Post Advanced ends – 9 RUN LIMIT

A.M. START TIME ALL ARENAS: 8:00 a.m. **NOTE: 20 RUNS PER CLASS OF STOCK PER TRIAL, PROVIDED STOCK IS AVAILABLE**

P.M. START TIME ALL ARENAS 1:15 p.m. or 30 min. following the last a.m. run or following handler's meeting

LUNCH BREAK: 12:00 to 12:45, unless otherwise posted

AWARDS to be given for the a.m. and p.m. trials: Daily AFTER both trials are over. Meet at the Duck Arena

SCORES WILL BE POSTED at the duck arena as timely as possible so you'll be able to check to see if you are qualified to move-up

RUNS FOR SALE: These will be posted at the duck arena area in the tent area

SUBSTITUTIONS must be made PRIOR to start time. **NO ENTRY ACCEPTED WITHOUT AN ENTRY BLANK/NO EXCEPTIONS**

HANDLERS MEETING: 30 minutes prior to start time – **MEET** at the Duck Arena under the tent area

Friday REGULAR TRIAL a.m.	ARENA B/COURSE B – SHEEP ARENA A/COURSE A – CATTLE ARENA C/COURSE B – DUCKS	Rick Pinney (run order: started, open, advanced) Rachael Vest (run order: advanced, open, started) Roy Sage (run order: advanced, open, started)
Friday REGULAR TRIAL p.m.	ARENA B/COURSE B – SHEEP ARENA A/COURSE A – CATTLE ARENA C/COURSE B – DUCKS	Rachael Vest (run order: started, open, advanced) Roy Sage (run order: advanced, open, started) Rick Pinney (run order: advanced, open, started)
Saturday REGULAR TRIAL a.m.	ARENA A/COURSE A – SHEEP ARENA B/COURSE B – CATTLE ARENA C/COURSE B – DUCKS	Roy Sage (run order: started, open, advanced) Rick Pinney (run order: advanced, open, started) Rachael Vest (run order: advanced, open, started)
Saturday REGULAR TRIAL p.m.	ARENA A/COURSE A – SHEEP ARENA B/COURSE B – CATTLE ARENA C/COURSE B – DUCKS	Rick Pinney (run order: started, open, advanced) Rachael Vest (run order: advanced, open, started) Roy Sage (run order: advanced, open, started)
Sunday REGULAR TRIAL a.m.	ARENA B/COURSE B – SHEEP ARENA A/COURSE A – CATTLE ARENA C/COURSE B – DUCKS	Rachael Vest (run order: started, open, advanced) Roy Sage (run order: advanced, open, started) Rick Pinney (run order: advanced, open, started)
Sunday REGULAR TRIAL p.m.	ARENA B/COURSE B – SHEEP ARENA A/COURSE A – CATTLE ARENA C/COURSE B – DUCKS	Roy Sage (run order: started, open, advanced) Rick Pinney (run order: advanced, open, started) Rachael Vest (run order: advanced, open, started)

BITCHES IN HEAT: run in order.

RUN ORDER: drawn the night before – Entries taken day-of will run in order of receipt.

STOCK: 3-5 head of cattle-sheep (dependent upon entries) and 5 head/ducks per run

MOTELS/HOTELS/CAMPING ONSITE AND OFF

Super 8, 1611 Central Avenue	Moriarty (35 minutes)	505/832-6730
El Ranch Motel	Mountainair (20 minutes)	505/847-2577
Schaefer Hotel	Mountainair (20 minutes)	505/847-2888
Holiday Inn Express	Moriarty (35 minutes)	505/832-5000
Ponderosa Motel	Moriarty (35 minutes)	505/832-4404
Siesta Motel	Moriarty (35 minutes)	505/832-4565
Lariat Motel	Moriarty (35 minutes)	505/832-4351
Days Inn	Moriarty (35 minutes)	505/832-4451

NO VET ON-CALL !!!
A LIST OF LOCAL VETS WILL
BE SUPPLIED IN THE
REGISTRATION PACKET

CAMPGROUNDS

Zia RV Campground	Moriarty (35 minutes)	505/832-9796
Red Arrow Campground	Edgewood (one hour)	505/281-0893

Camping on site: **LIMITED ELECTRIC \$15/DAY (PRIMARILY for the handicapped, host's guests, & on-site workers).**

- **DRY CAMPING \$7.00/DAY /MAKE CHECK PAYABLE TO "LEGENDS"** (If you use a generator, it must be turned off at 10:00 p.m. each evening and cannot be ran during the duck trial or obedience trial)
- No dumping on site. THIS MEANS any bedding MUST NOT be left or dumped on the ranch. BAG IT, please.
- Portapotties will be on site, including a handicapped portapotty.
- Water is available as needed so campers may fill up upon arrival.
- **PAY THE HOST FOR CAMPING UPON YOUR ARRIVAL - NO PRE-PAYMENTS ACCEPTED.**

SHOW SITE DIRECTIONS: 671 Langley Road (AO32), Estancia, NM 505/384-2547

► LEAVING ALBUQUERQUE/HEADING EAST:

From I-40 east of Albuquerque, get off in Tijeras and take 337. Head south, staying on 337 (about 37 miles) until it deadends into Highway 55. Turn left heading east. Watch for milemarker 89 on your righthand side (that is county road AO27/**Riley Road**). Turn right; it's a blacktop road. Go down until you come to the first dirt road that turns left; there is a cluster of mailboxes at the corner (Shope is not among them); this is AO32/Langley Road. Turn left onto AO-32, Langley Road. The ranch is the first entrance on your lefthand side.

► COMING FROM SOCORRO HEADED TOWARDS BELEN/HEADING NORTH:

From I-25 south of Albuquerque, take highway 60 to Mountainair. Turn left from Mountainair onto highway 55; watch for highway 542, turn right onto that highway. Then watch for county road AO27 (about milemarker 8). Turn left onto AO27/**Riley Road** (it starts out dirt and then goes to black top) and follow it down to county road AO32. AO-32, Langley Road is a dirt road to your right; watch for the cluster of mailboxes on the corner, turn right on AO-32, Langley Road and the ranch is the first entrance you'll come to on your lefthand side.

► COMING FROM RATON/LAS VEGAS/GLORIETA/HEADING SOUTH:

From I-25 north of Santa Fe (bypassing Santa Fe & Albuquerque both), take highway 285 just outside of Glorieta. Then take the right fork onto highway 41. Follow highway 41 into Moriarty and then on into Estancia. At Estancia, go through the town to the end at which time you'll come to highway 55, turn right and follow it until you see AO30 (Ranchhouse Road)(it's before mile marker 89). Watch on your lefthand side for AO30; turn left onto AO30; it'll deadend into AO32 (no sign for the road). Turn right and the ranch is the first entrance you'll come to on your righthand side.

► COMING FROM CLOVIS ON HIGHWAY 60

Watch for the exit for highway 41 that goes into Estancia. Turn right onto highway 41. Just before you get to Estancia, you'll come to highway 55. Turn left onto highway 55. Follow it until you see AO30 (Ranchhouse Road)(it's before mile marker 89). Watch on your lefthand side for AO30; turn left onto AO30; it'll deadend into AO32 (no sign for the road). Turn right and the ranch is the first entrance you'll come to on your righthand side. If you pass AO30/Ranchhouse Road, you'll come to milemarker 89/Riley road, AO27 – follow instructions above for that road.

PLEASE DRIVE IN SLOWLY. SOMEONE WILL ASSIST YOU IN FINDING A PARKING SPOT. IF THE WEATHER IS RAINY, YOU'LL BE ASKED TO PARK ON THE DRIVE COMING INTO THE RANCH, RATHER THAN IN THE YARD AREA. IT IS VERY EASY TO GET STUCK HERE.

TIE AWNINGS AND TENTS DOWN TIGHTLY, PLEASE. PICK UP AFTER YOUR DOG AND YOUR SETUP. LASA & THE HOSTS THANK YOU☺

RANCH TRIAL INSTRUCTIONS - drawing NOT to scale

- 1) Gather from Arena B to Take-Pens. Sort 3 marked head into Pen 2. Sort 7 into either Pen 3, 4, or 5 (your choice). You may sort in any order but 3 marked must end up into Pen 2.
- 2) Move your three marked from Pen 2 into Pen 9 and then from Pen 9 into Pen 7 and then into Arena A.
- 3) Move 3 head in Arena A to Pen/Chute and load those into the Trailer. You must load your stock into the trailer in order to go on. Unload the 3 marked head and then take these to Pen 7 and from Pen 7 into Pen 6 and leave there.
- 4) Go back to Arena B and take remaining 7 unmarked head from the take-pen you chose and move them into pen 2, then into pen 9 and then into Pen 6 to join the 3 marked head.
- 5) Remove all 10 head (marked & unmarked) from pen 6 into the Pasture area and fetch/drive to the chute marked 8 and then return the 10 head to Arena B (gate to Arena B is located by Pen 6).

Time ends when you close Arena B gate.

TIME LIMIT: 20 MINUTES

Ranch Trial & Post Advanced: Barbwire fencing along all fence lines outside the arena.

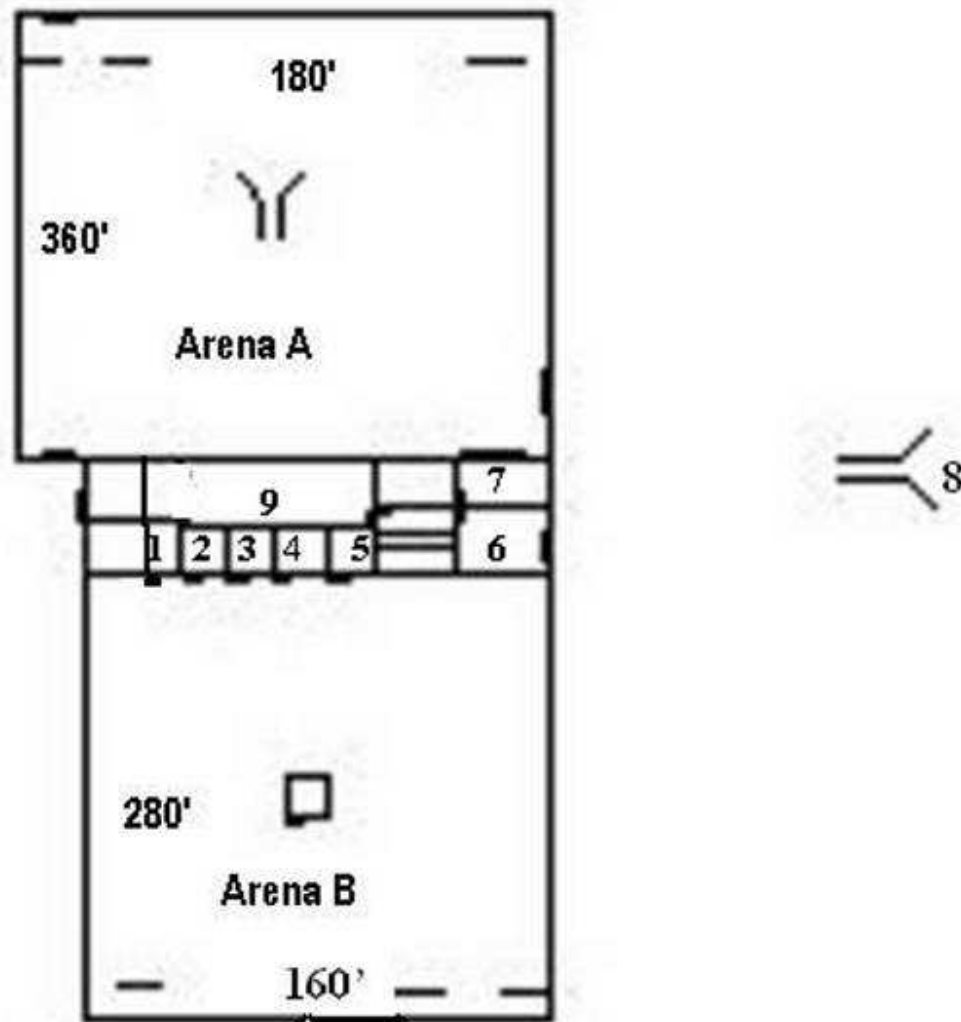

**YOU AGREE by your participation to pay
REPLACEMENT COST OR VET FEE AS
APPLICABLE FOR INJURY OR DEATH OF AN
ANIMAL in the regular trials or in the ranch trials or post
advanced trials: DUCKS \$25 SHEEP \$150
CATTLE \$MARKET PRICE**

**Terrain is dryland pasture and can be rough footing in the
Arenas and outside the Arenas.**

Entry fees will not be returned if the show cannot be opened or be completed due to riots, civil disturbances, acts of God, public emergencies or other events beyond the control of Lobo ASA. Entry fees will not be refunded if the dog is absent, disqualified, excused or barred from competition by the Show Committee, ASCA, Host, show veterinarian or the judge.



POST ADVANCED COURSE: The course will be held in the pasture south of the middle of the Arenas A&B. See the Chute labeled #8 to the left; it's part of the PATD course. That chute is about 300' away from Takepen 6. Barbwire fencing surrounds this 80 acre pasture in which the PATD Course is situated. The course itself is about 600 x 415 feet.

POST ADVANCED TRIAL DOG IS FOR DOGS THAT HAVE BEEN CERTIFIED OR HAVE QUALIFIED FOR THE ADVANCED TRIAL DOG FOR THE CLASS BEING ENTERED.

ARENA A (back) - Course A - 180 X 360 DRAWING LEFT TAKE PEN #7 20 x 20
ARENA B (front) - Course B - 160 X 280 DRAWING LEFT TAKE PEN #6 ~20 x 20
ARENA C - Ducks - Course B - 60 X 90 DRAWING LEFT TAKE PENS #1-#5 16 X 16

Ducks are Indian Runners and/or Khaki Campbells
Sheep Barbados & Mixed Woolies Cattle Feeders

Duck Arena is southwest of Arenas A & B.

**RETURN THIS RECAP SHEET WITH YOUR ENTRY BLANK, PLEASE
(Junior handlers pay same price as named below)**

YOUR NAME: _____ (PHONE/EMAIL) _____

	Pre-Entry	Day-Of	No. of Dogs	Remitted
STOCK: MAKE CHECK PAYABLE TO "LASA"	<small>Same fees per class of stock: feo & open working junior. {Same fees: working jr handler, novice handler dog (open to anyone over 17 who has never put an open title on a dog) – please refer to the ASCA Stockdog Rulebook for more particulars – WJH & NHD ARE NO TITLE CERTIFICATE EVENTS}}</small>			
Post Advanced Trial cattle or sheep	\$55.00	\$60.00	_____	\$ _____
Ranch Trial cattle or sheep	\$55.00	\$60.00	_____	_____
Cattle - Regular Trial (Fri, Sat and/or Sun)	\$40.00 each trial	\$45.00	_____	_____
Sheep - Regular Trial (Fri, Sat and/or Sun)	\$35.00 each trial	\$40.00	_____	_____
Ducks - Regular Trial (Fri, Sat and/or Sun)	\$25.00 each trial	\$30.00	_____	_____
Entering all three classes of stock (Friday)	\$95.00 each trial	\$100.00	_____	_____
Entering all three classes of stock (Saturday)	\$95.00 each trial	\$100.00	_____	_____
Entering all three classes of stock (Sunday)	\$95.00 each trial	\$100.00	_____	_____
Entering all three classes of stock (Fri-Sun)*	\$480.00 same dog	\$550.00	_____	_____ (*discount 6 trials)
Most Versatile Australian Shepherd	\$ 5.00	\$ 10.00	_____	_____
Stockdog Handlers Fee (one time fee per entrant)	\$ 5.00	\$ 5.00	_____	_____ **

This offsets the club's cost for keeping our workerbees fed & watered down. **If you are a workerbee, your lunch & drinks are free the day you work (must work or time keep for one entire class of stock). We appreciate anyone who volunteers to help us at any of the three arenas.

SATURDAY NIGHT BARBECUE: MAKE CHECK PAYABLE TO "KATY'S BARBECUE" & send with your entry
 \$10.00 \$12.00 People _____

**LOBO ASA SEVENTH ANNUAL THREE PINE RANCH CLASSIC
SPONSORSHIP OPPORTUNITIES & THANK YOUS!**

\$100 flat fee (special prizes: coats or director's chairs or buckles or ...)

- MPS Aussie/3-day avg..... _____
- MPS Other Breed/3-day avg..... _____
- HC Aussie/3-day avg..... _____
- HC Other Breed/3-day avg..... _____
- HIT Stockdog RTD/PATD..... _____
- Most Versatile Australian Shepherd. _____
- Stock/\$10.00 flat fee (any) _____

We will have a large Poster Board with everyone's names who have donated to the Classic. We thank you for your sponsorship!!!

PRIMARY SPONSOR: ANYONE WHO DONATES \$200 IN SPONSORSHIPS - FREE TICKET TO BARBECUE AND A FREE STRETCH FOR THE RAFFLE

HOW WOULD YOU LIKE YOUR SPONSORSHIP TO APPEAR?

NAME: _____

KENNEL: _____

LASA OFFICERS

President: Stephanie Shope-McDaniel
stephshelby99@yahoo.com

Vice President: Diana Decker

Secretary: Anne Shope

Treasurer: Tammy Seaman Decoloraussies@aol.com

Board Members: Anne Shope, Affiliate Representative,
Kim Monti & Karen Lightfoot

CLASSIC PHOTOGRAPHER

There will be a photographer on site. Watch for the announcement and particulars in your registration packet.

VENDORS ON SITE

VENDORS: Contact Stephanie Shope McDaniel for a vendor spot. Fee is \$25 for the entire trial
Make check payable to: LASA

RAFFLE: Don't miss it; drawing is on Sunday. Need not be present to win.

Lobo Australian Shepherd Club is now seven years young. Our members participate in stockdog events, conformation, obedience, and agility plus. We have members who are stockdog, conformation and obedience judges plus members with ASCA Hall of Fame Australian Shepherd kennels, sires and dams. Our members owning other breeds are viable members of our club and you'll find them serving as club officers and also as trial course directors for some of our stockdog trials. You'll also find them running off with our prizes & ribbons periodically☺

The primary focus of Lobo is retaining stockdog instinct and capability and showcasing that genetic talent. Education via our club chatlist, website and our community projects is on-going. YOU are invited to join our club where we all hope to become

your new best friends. **Please pick up an Application at the registration table or request one from a Lobo member.**

LASA WEBSITE: <http://www.geocities.com/loboasanm>

**KATY'S CARRYOUT is our DAILY vendor.
Excellent Food (breakfast, lunch & dinner).**

PLEASE SUPPORT OUR VENDOR.

**DON'T MISS THE SATURDAY NIGHT
BARBECUE. OUR VENDOR WOULD
APPRECIATE EVERYONE THAT CAN PAYING
IN ADVANCE FOR THE BARBECUE SO THEY
COOK ENOUGH FOOD FOR EVERYONE.
THEY WILL TAKE SOME DAY-OF ORDERS
ALSO☺ SEE THE VENDOR EARLY IN THE
DAY IF YOU FORGOT TO RESERVE YOUR
SATURDAY DINNER; THEY MAY BE ABLE TO
TAKE YOUR RESERVATION.**

**CHECK WITH ASANM. THEY ARE HOSTING
THE CONFORMATION (2) & OBEDIENCE (1)
SHOWS ON SATURDAY OF THE CLASSIC!
For more information & the flyer, contact**

**Tammy Seaman 505/877-4771
Decoloraussies@aol.com**

