

*DECK PLANS VALID AS OF JANUARY 1, 2009. SUBJECT TO CHANGE AT ANY TIME.
 *Certain staterooms may vary in size and configuration. Photos and diagrams represent typical arrangements. Call Princess Cruises for more information.

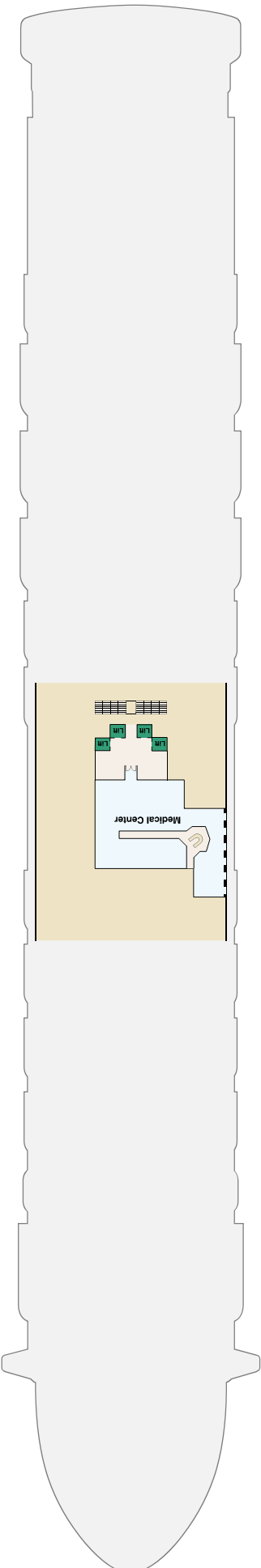
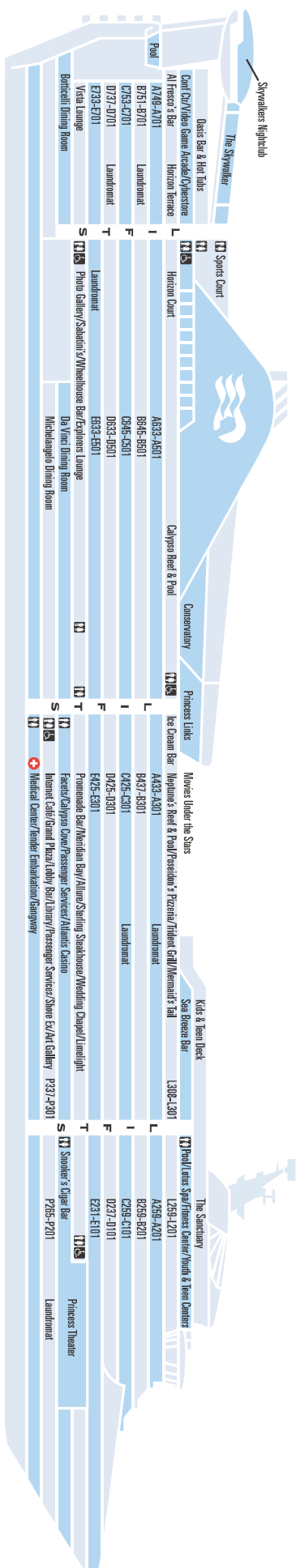

DECK PLAN KEY & ROOM DESCRIPTION

Room Description	Color	Category
------------------	-------	----------

PUBLIC AREAS LOCATED ON THIS DECK

1. Medical Center

DECK ICON KEY

- Interconnecting staterooms with private balcony (8 persons)
- Two lower beds not convertible to queen; shower only
- Will accommodate third and fourth person
- Will accommodate third person
- Wheelchair-accessible

*DECK PLANS VALID AS OF JANUARY 1, 2009. SUBJECT TO CHANGE AT ANY TIME.
 *Certain staterooms may vary in size and configuration. Photos and diagrams represent typical arrangements. Call Princess Cruises for more information.

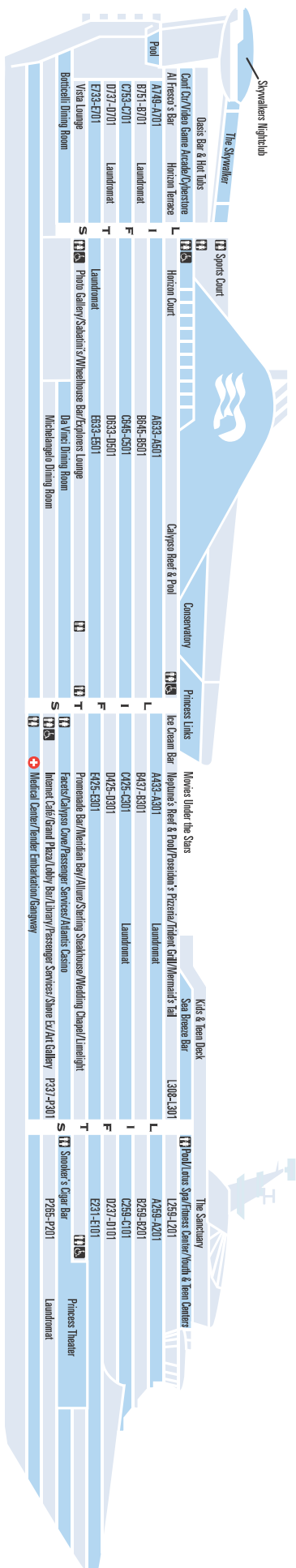

DECK PLAN KEY & ROOM DESCRIPTION	
Room Description	Color Category
Interior Double	■ K
Interior Double	■ L
Interior Double	■ M
Oceanview Double	■ D
Oceanview Double	■ EE

PUBLIC AREAS LOCATED ON THIS DECK

1. Circle Desk
2. Future Cruise Sales
3. Grand Plaza
4. Internet Café
5. Lobby Bar
6. Michelangelo Dining Room
7. Passenger Services
8. A Quiet Corner
9. Princess Fine Arts Gallery
10. Shore Excursions Desk

DECK ICON KEY

- ▲ Interconnecting staterooms with private balcony (8 persons)
- ✳ Two lower beds not convertible to queen; shower only
- Will accommodate third and fourth person
- ◆ Will accommodate third person
- Wheelchair-accessible

*DECK PLANS VALID AS OF JANUARY 1, 2009. SUBJECT TO CHANGE AT ANY TIME.
 *Certain staterooms may vary in size and configuration. Photos and diagrams represent typical arrangements. Call Princess Cruises for more information.

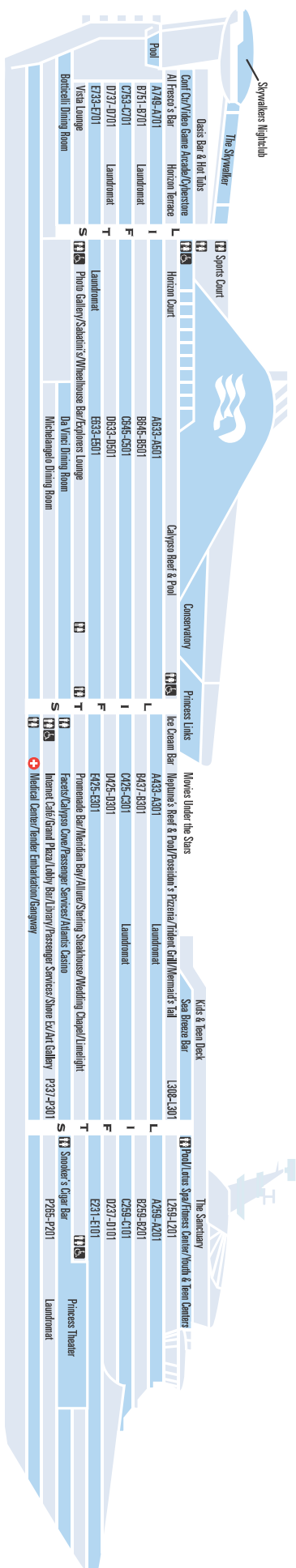

DECK PLAN KEY & ROOM DESCRIPTION	Color	Category
----------------------------------	-------	----------

PUBLIC AREAS LOCATED ON THIS DECK

DECK ICON KEY

1. Atlantis Casino
2. Botticelli Dining Room
3. Boutiques
4. Calypso Cove
5. Da Vinci Dining Room
6. Passenger Services
7. Princess Theatre
8. Snooker's Cigar Bar

- ▲ Interconnecting staterooms with private balcony (8 persons)
- * Two lower beds not convertible to queen; shower only
- Will accommodate third and fourth person
- ◆ Will accommodate third person
- Wheelchair-accessible

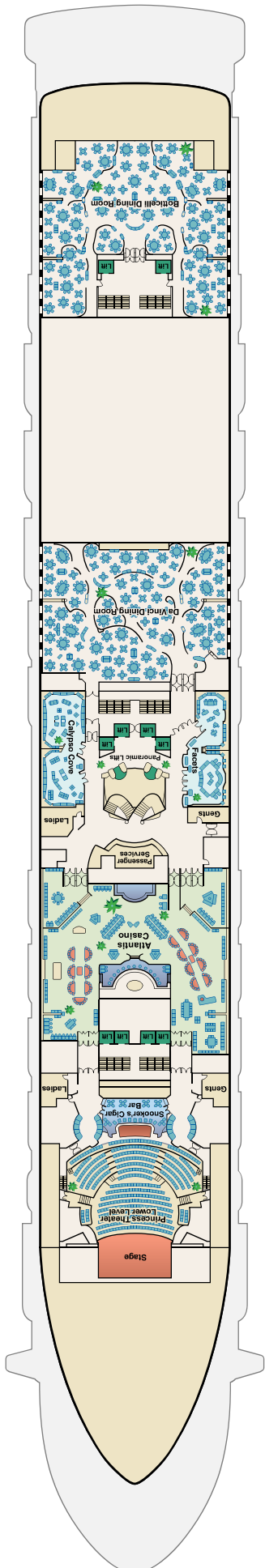

*DECK PLANS VALID AS OF JANUARY 1, 2009. SUBJECT TO CHANGE AT ANY TIME.
 *Certain staterooms may vary in size and configuration. Photos and diagrams represent typical arrangements. Call Princess Cruises for more information.

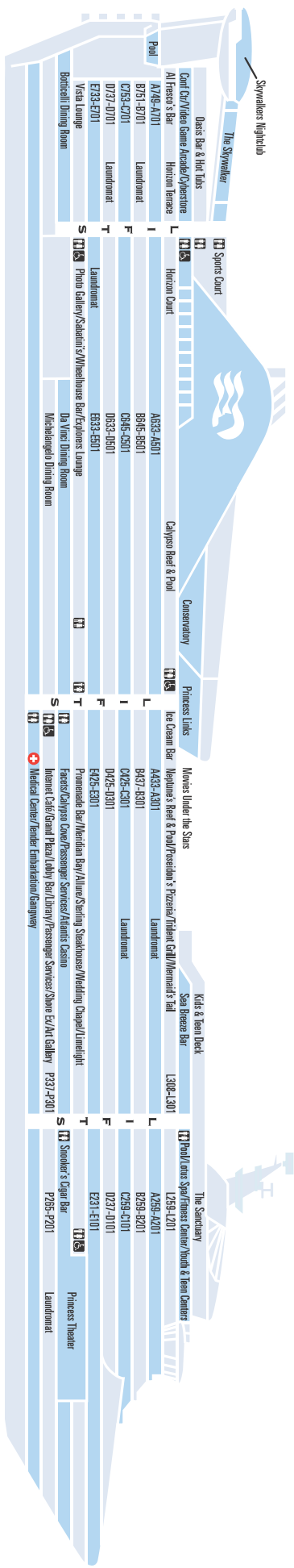

Room Description	Color	Category
------------------	-------	----------

- ### PUBLIC AREAS LOCATED ON THIS DECK
1. Explorers Lounge
 2. Hearts & Minds Wedding Chapel
 3. Meridian Bay
 4. Photo Gallery
 5. Princess Theatre
 6. Promenade Galleria
 7. Promenade Lounge & Bar
 8. Sabatini's
 9. Boutiques
 10. Sterling Steakhouse
 11. Vista Lounge
 12. Wheelhouse Bar

DECK ICON KEY

	Interconnecting staterooms with private balcony (8 persons)
	Two lower beds not convertible to queen; shower only
	Will accommodate third and fourth person
	Will accommodate third person
	Wheelchair-accessible

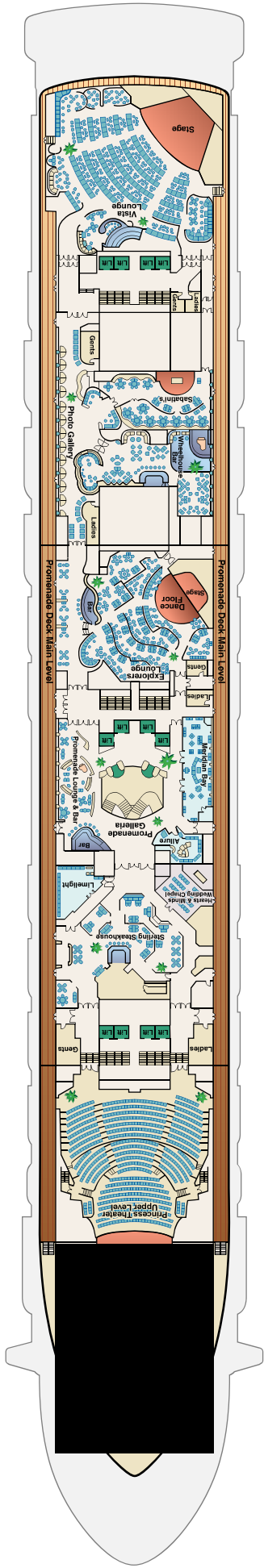

*DECK PLANS VALID AS OF JANUARY 1, 2009. SUBJECT TO CHANGE AT ANY TIME.
 *Certain staterooms may vary in size and configuration. Photos and diagrams represent typical arrangements. Call Princess Cruises for more information.

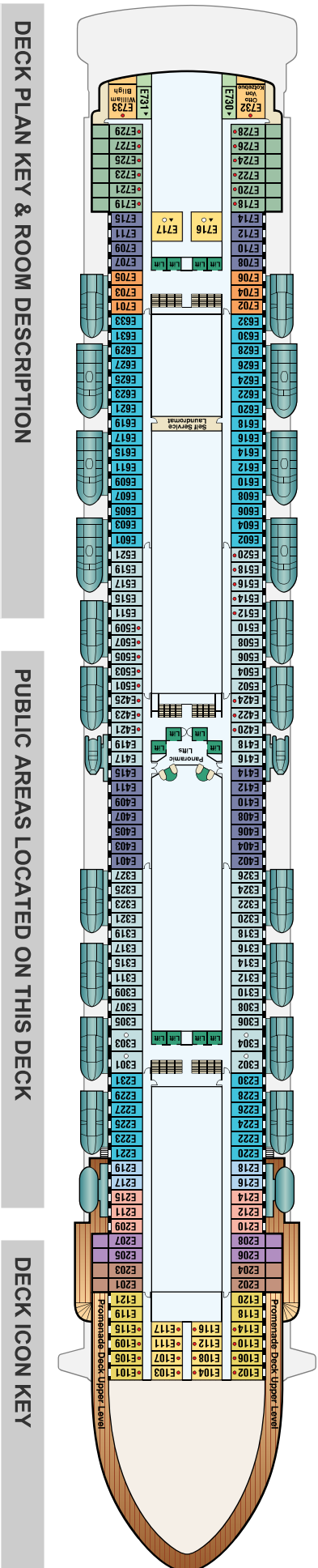
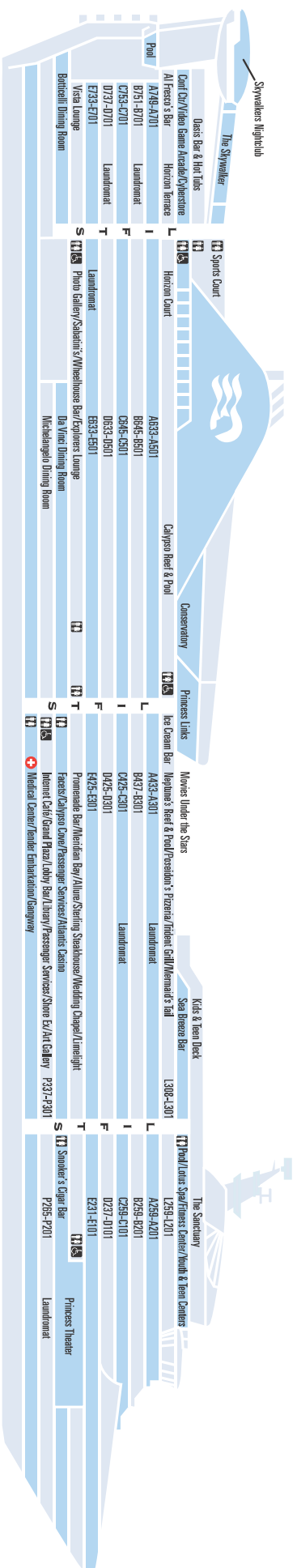

Room Description	Color	Category
Interior Double	Yellow	J
Mini-Suite With Balcony	Light Green	AD
Oceanview Double	Yellow-Green	DD
Oceanview Double With Balcony	Light Green	BB
Oceanview Double With Balcony	Purple	BE
Oceanview Double With Balcony	Brown	BF
Oceanview Obstructed	Dark Blue	E
Oceanview Obstructed	Light Blue	F
Oceanview Obstructed	Light Blue	FF
Oceanview Obstructed	Light Blue	G
Oceanview Obstructed	Orange	G
Oceanview Obstructed	Orange	HH
Suite With Balcony	Orange	VS

PUBLIC AREAS LOCATED ON THIS DECK

DECK ICON KEY

- Interconnecting staterooms with private balcony (8 persons)
- Two lower beds not convertible to queen; shower only
- Will accommodate third and fourth person
- Will accommodate third person
- Wheelchair-accessible

*DECK PLANS VALID AS OF JANUARY 1, 2009. SUBJECT TO CHANGE AT ANY TIME.
 *Certain staterooms may vary in size and configuration. Photos and diagrams represent typical arrangements. Call Princess Cruises for more information.

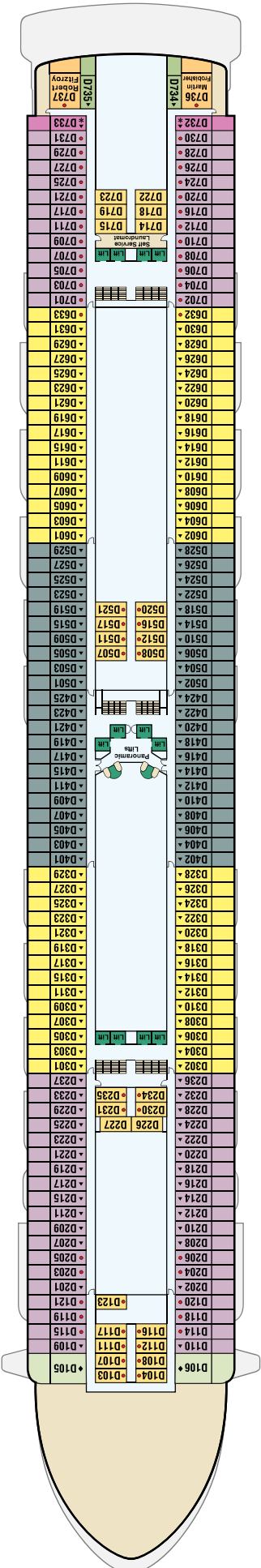
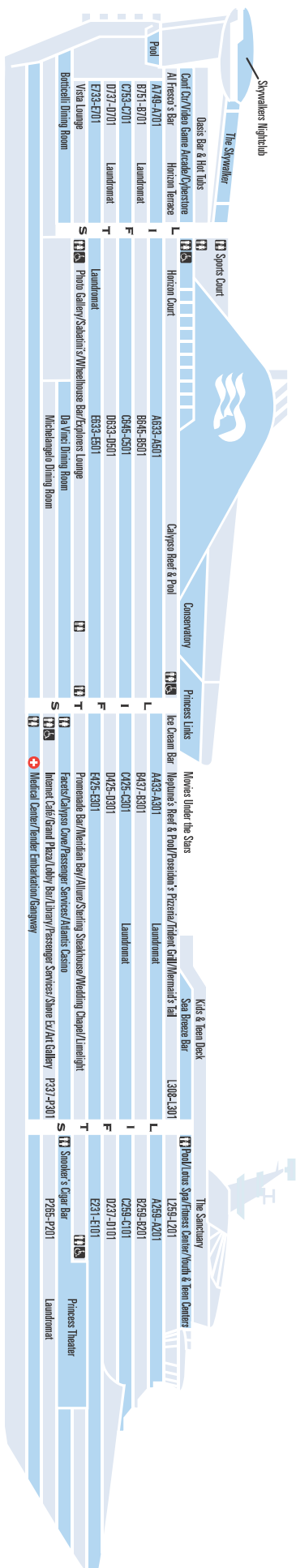

DECK PLAN KEY & ROOM DESCRIPTION

Room Description	Color	Category
Family Suite		XS
Interior Double		J
Mini-Suite With Balcony		AA
Mini-Suite With Balcony		AB
Mini-Suite With Balcony		AC
Mini-Suite With Balcony		AE
Oceanview Double With Balcony		BB
Suite With Balcony		VS

PUBLIC AREAS LOCATED ON THIS DECK

DECK ICON KEY

- Interconnecting staterooms with private balcony (8 persons)
- Two lower beds not convertible to queen; shower only
- Will accommodate third and fourth person
- Will accommodate third person
- Wheelchair-accessible

*Certain staterooms may vary in size and configuration. Photos and diagrams represent typical arrangements. Call Princess Cruises for more information.

*DECK PLANS VALID AS OF JANUARY 1, 2009. SUBJECT TO CHANGE AT ANY TIME.

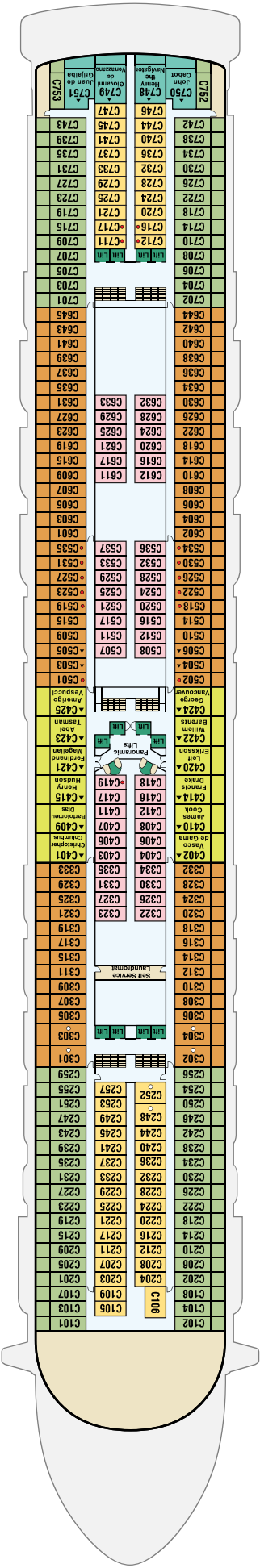
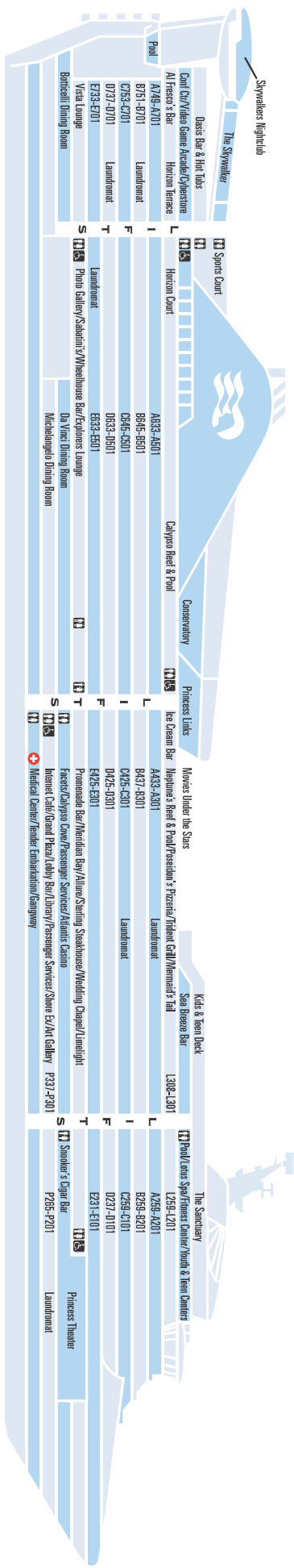

DECK PLAN KEY & ROOM DESCRIPTION

Room Description	Color	Category
Interior Double		J
Interior Double		JJ
Oceanview Double With Balcony		BA
Oceanview Double With Balcony		BB
Suite With Balcony		PH
Suite With Balcony		PS

PUBLIC AREAS LOCATED ON THIS DECK

DECK ICON KEY

- Interconnecting staterooms with private balcony (8 persons)
- Two lower beds not convertible to queen; shower only
- Will accommodate third and fourth person
- Will accommodate third person
- Wheelchair-accessible

