

Enabling Chinese Input in Windows XP Professional

Install East Asian Language Support

1. Have your Windows XP Pro cd-rom ready
2. Click on START > CONTROL PANEL > REGIONAL & LANGUAGE OPTIONS
3. Choose the LANGUAGES tab and check the box INSTALL FILES FOR EAST ASIAN LANGUAGES

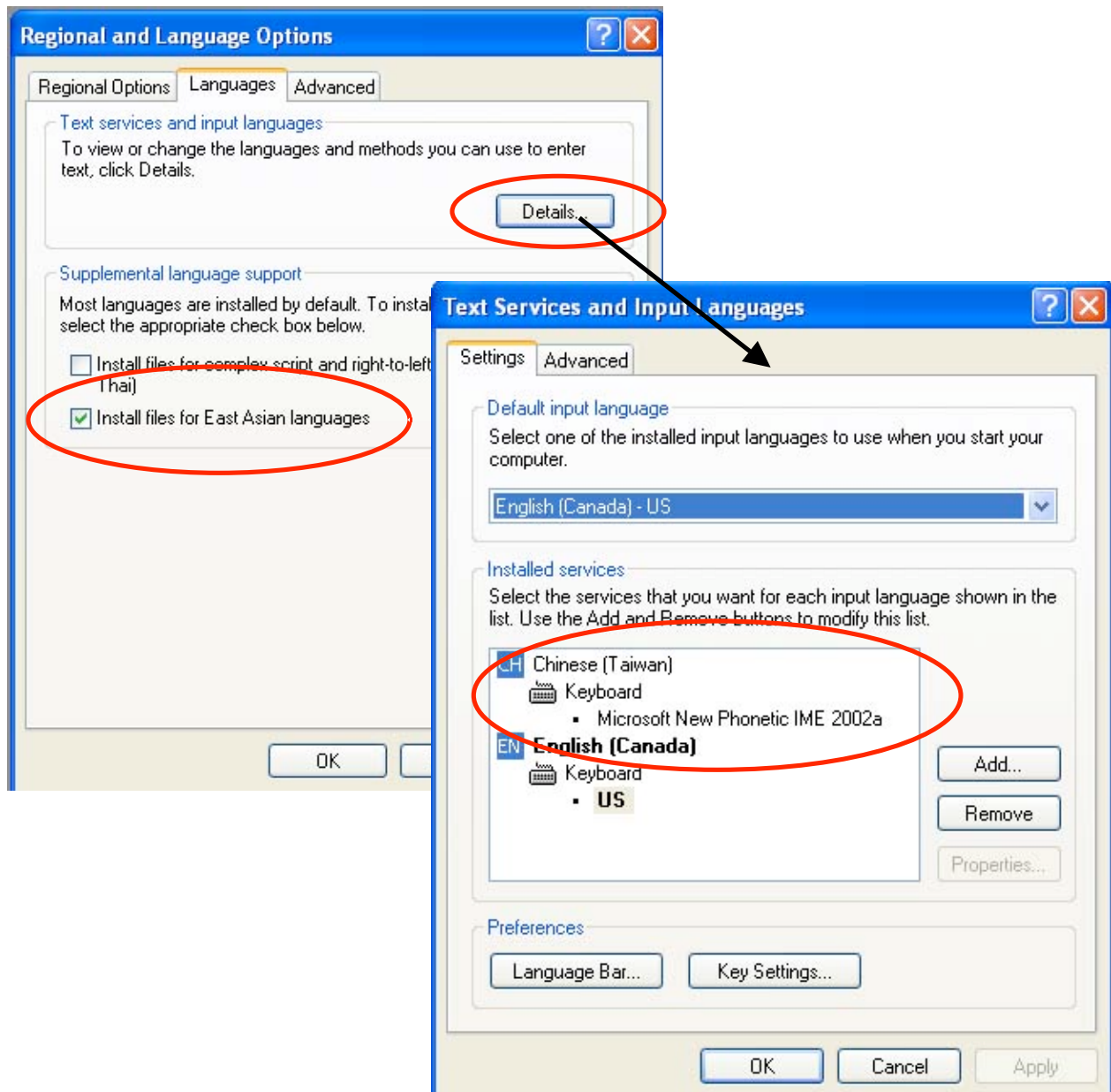

4. Click on DETAILS in the section above called TEXT SERVICES AND INPUT LANGUAGES
5. Under the INSTALLED SERVICES, click on ADD and choose:
 - Input Language: Chinese (Taiwan)
 - Keyboard layout/IME: leave as is

* If you would like to use more than one input method (such as Chang Jie or Phonetic), repeat this step again but choose a different keyboard layout/ime.
6. Click OK in the ADD INPUT LANGUAGE window and OK in the TEXT SERVICES AND INPUT LANGUAGES window.
7. Under PREFERENCES, click on LANGUAGE BAR. Make sure the option SHOW THE LANGUAGE BAR ON THE DESKTOP is checked off.
8. Click OK for the windows open and it should ask you for your Windows XP cd-rom.

Opening the Chinese Input Method Toolbar

In your taskbar (the bar on the bottom of the screen), in the right hand corner there should be a symbol that looks like this:



1. Click on it and choose SHOW THE LANGUAGE BAR
2. A tool bar should appear at the top of your screen. Click on EN ENGLISH (UNITED STATES) and choose CH CHINESE (TAIWAN).



3. Click on TOOLS > IME PAD. This will open a window which you can use your mouse (or tablet if you have one) to “write” Chinese.



