

COUNTY  
 OF ...  
 ...  
 ...

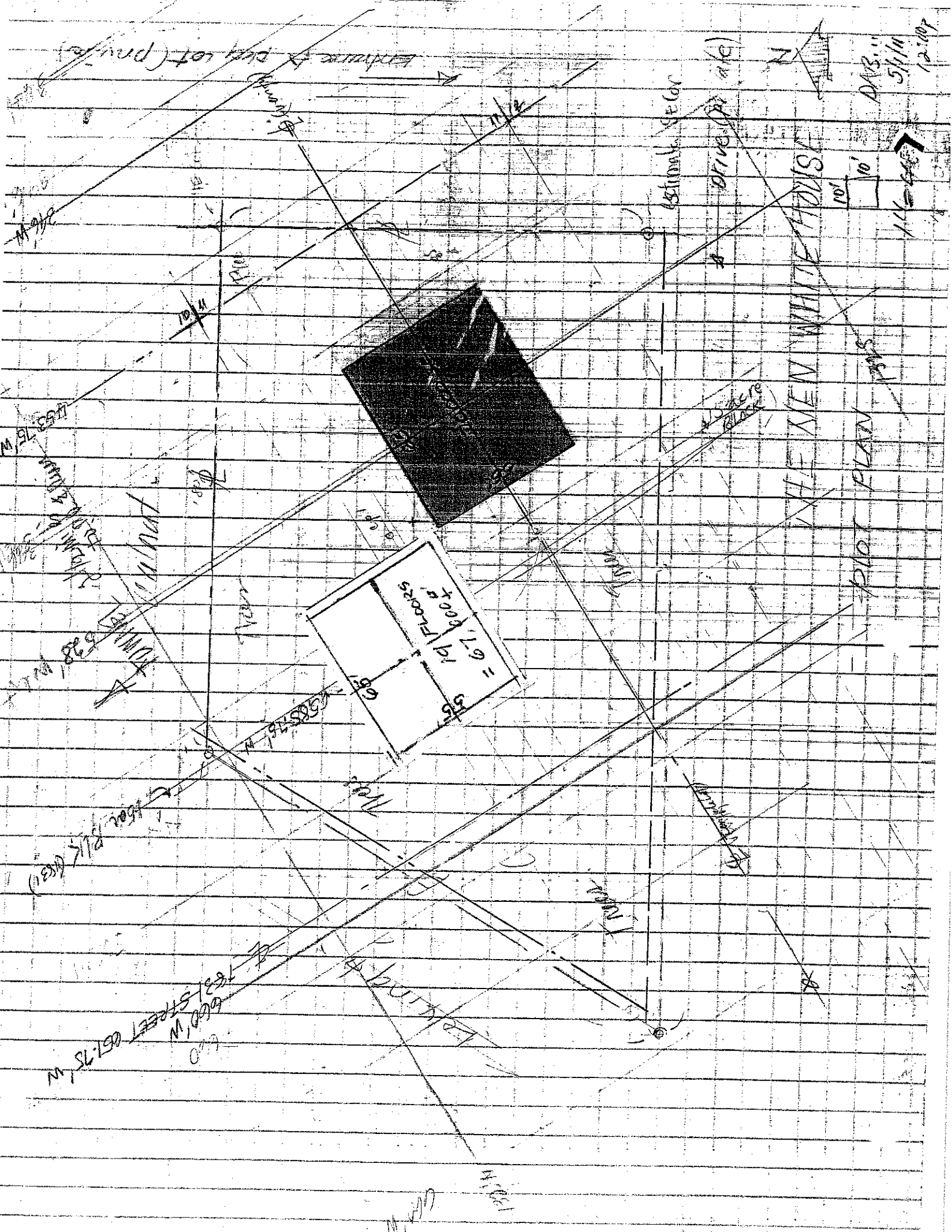







ENTRANCE TO PLOT (PARK)

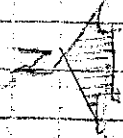

ANS. 11  
5/1/11  
12.1007

67, 19 FLOORS = 67, 19 BOOKS

NEW WHITE HOUSE

PILOT PLAN

LAWRENCE ST  
W. 1500 BLK (630)

ESTIMATE SE COR



DRIVE (A) (A/E)

W. 1500 BLK (630)  
LAWRENCE ST

11.200

# Exhibit VII.2 Arterial Road Network

## EGEND

-  Existing County Major Arterials and Freeways
-  Proposed County Major Arterials and Freeways
-  City Limits

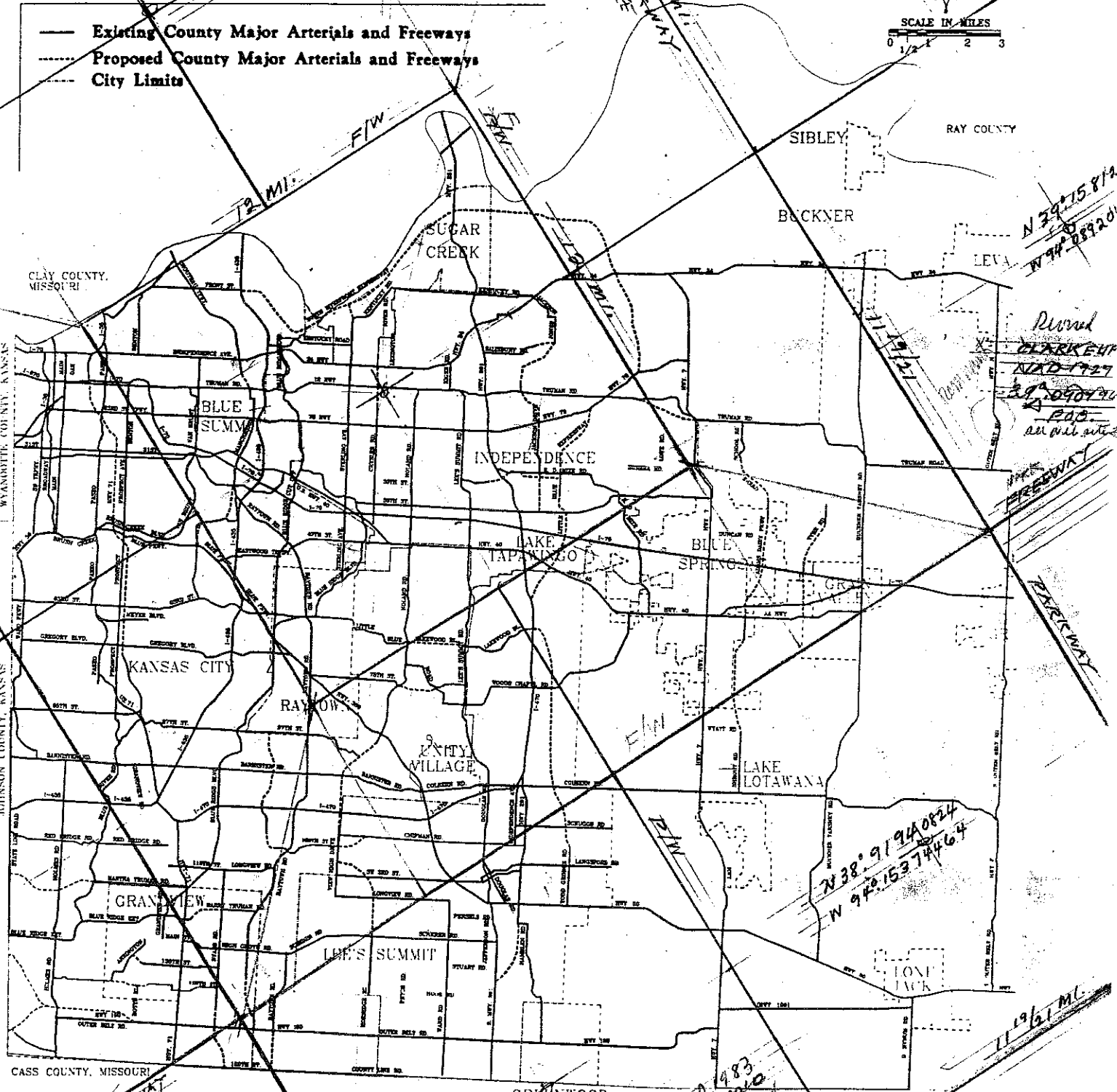

Department of Public Works  
 Gordon P. Braun, Director  
 CIVIL ENGR

Missouri

P.O.B.N. COORDINATES ON NAD 1983  
 NAD 1927 CLARK ELLIPSOID  
 KYMAK (guidelines)  
 11/16/95 805... all within



F-L-C PLANNING GROUP  
 LAW FIRM

11 1/2 MI  
 FREEWAY

N 39° 15' 81.2"  
 W 94° 08' 20.4"

Revised  
 CLARK EHP  
 NAD 1927  
 39° 09' 09.9"  
 P.O.B.  
 all within

N 38° 9' 194.0824"  
 W 94° 15' 374.64"

11 1/2 MI  
 FREEWAY

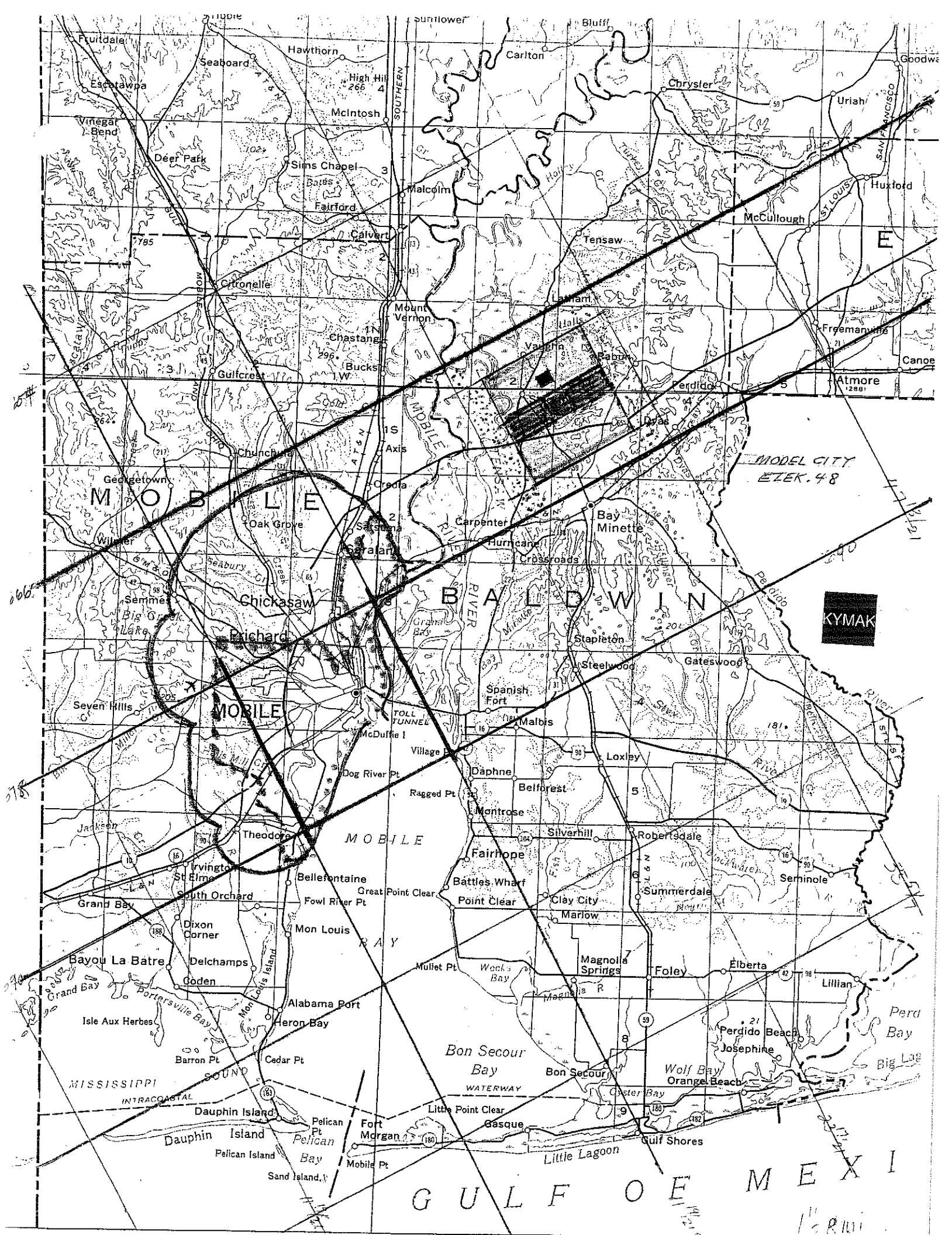

MODEL CITY  
ETEK. 48

KYMAK

GULF OF MEXICO

7040  
11 2/3 miles

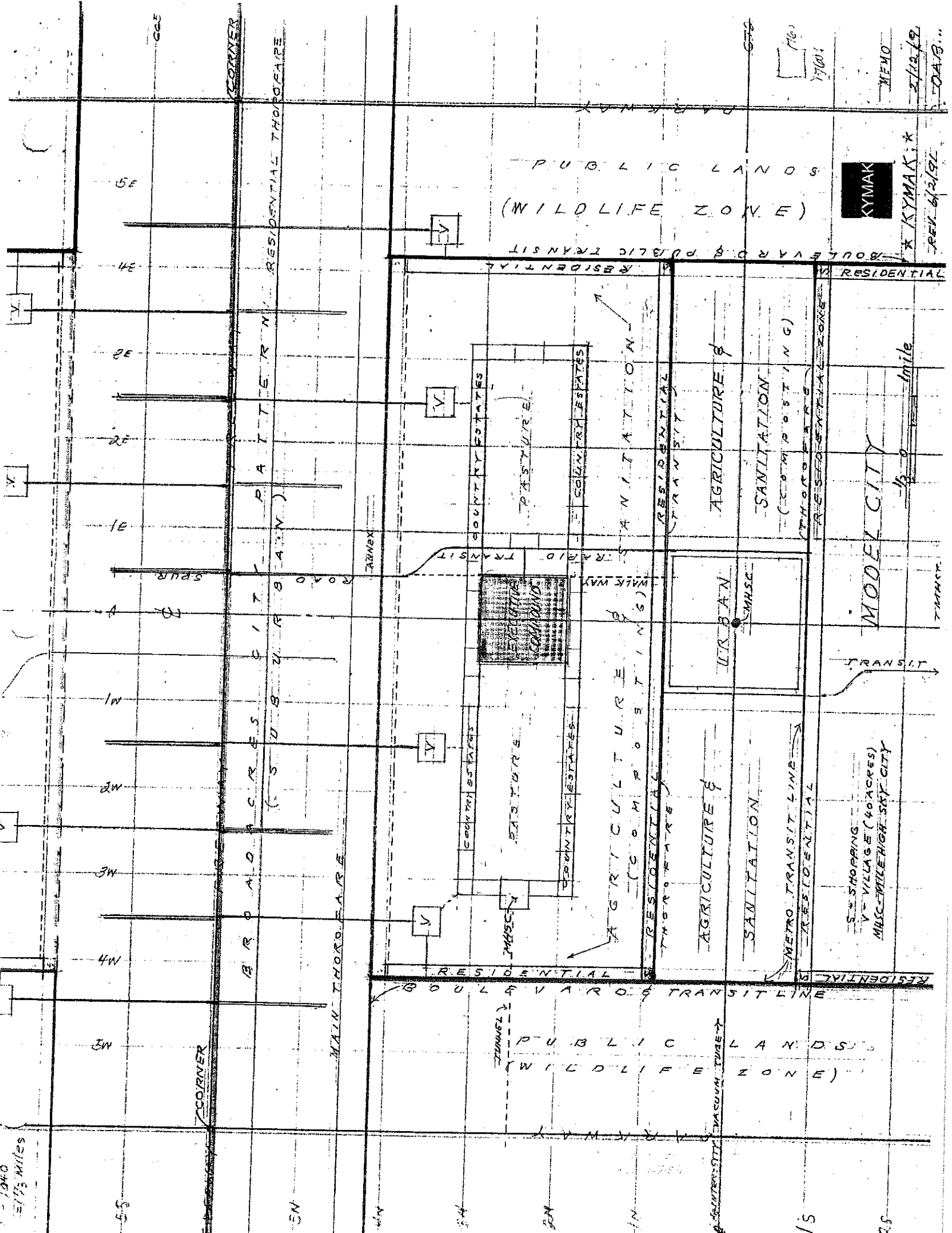

KYMAK

\* KYMAK: K  
REV. 6/2/91

MODEY CITY

1/2 mile

SHOPPING VILLAGE (40 ACRES)  
MISC. MILE HIGH SKY CITY

MEMO  
2/12/91  
DAB...



2 1/2" = 1 mi.  
 1/4" = 0.1 mi.  
 = 5280'

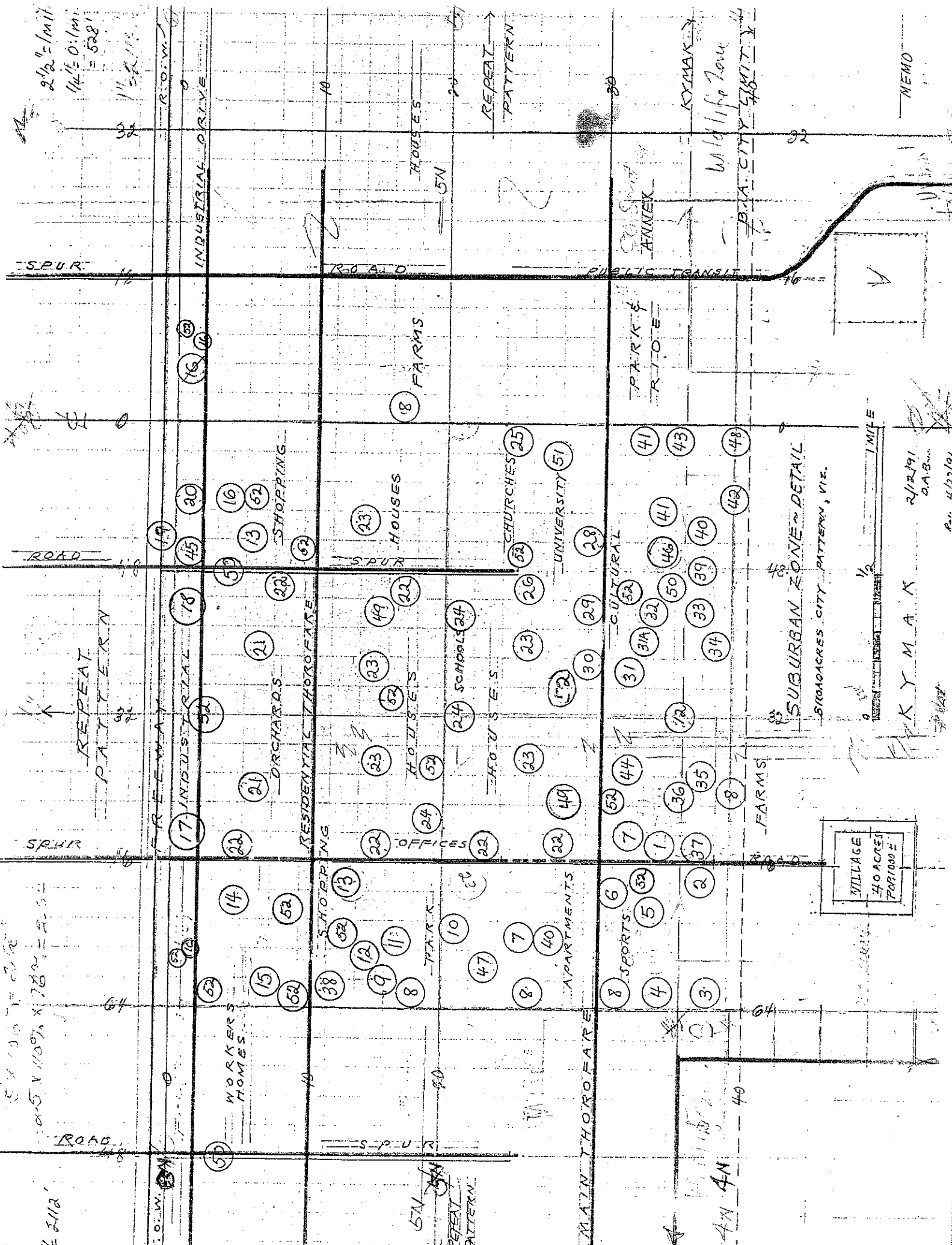

5 x 10 = 20  
 100 x 100 = 10000  
 10000 x 100 = 1000000

VILLAGE  
 40 ACRES  
 POP 1000

1 MILE  
 1/2  
 0

PARK Y M A X  
 2/12/91  
 D.A.B.  
 P. U. S. 10101

MEMO

KEY MAP: SITE SELECTIONDOUGLAS BOYD, Agent - AL 36607-0534

1/21/91

LEGEND: SUBURBAN ZONE (COMPREHENSIVE PLAN)\*

- |                                   |  |
|-----------------------------------|--|
| 1 COUNTY SEAT OR GOVT. ANNEX      | 27 AGRICULTURAL RESEARCH                 |
| 2 POST OFFICE                     | 28 ARBORETUM                             |
| 3 RACE TRACK                      | 29 ZOO                                   |
| 4 SPORTS FIELDS                   | 30 AQUARIUM                              |
| 5 SPORTS COMPLEX                  | 31 FAIR GROUNDS (OR EXHIBITS) 31A BEACON |
| 6 ATHLETIC CLUBS                  | 32 HOTEL                                 |
| 7 LAKE & STREAM                   | 33 COUNTRY CLUB                          |
| 8 FARM UNITS                      | 34 HOSPITAL OR SANITARIUM                |
| 9 LUXURY HOUSE                    | 35 SMALL INDUSTRIAL UNITS                |
| 10 INTERIOR PARK                  | 36 SMALLER OFFICES                       |
| 11 MUSIC GARDEN                   | 37 SMALL APARTMENTS                      |
| 12 HEALTH SPA                     | 38 DAIRY PRODUCTS                        |
| 13 SHOPPING CENTER                | 39 KINDERGARTEN, (OR DAY CARE CENTER)    |
| 14 MOTEL                          | 40 APARTMENT HOUSES                      |
| 15 WORKERS HOMES                  | 41 SPACIOUS LIVING                       |
| 16 FACTORIES WITH DWELLINGS ABOVE | 42 WATER SUPPLY RESERVOIR                |
| 17 MANUFACTURING                  | 43 PROFESSIONAL SCHOOLS                  |
| 18 TRUCK STOP                     | 44 COUNTY DESIGN PROFESSIONALS           |
| 19 FREEWAY                        | 45 SMALL THEATER                         |
| 20 INDUSTRIAL                     | 46 WILDERNESS CABINS                     |
| 21 VINEYARDS & ORCHARDS           | 47 LARGER HOMES                          |
| 22 OFFICES/SPACE                  | 48 OBSERVATION POINT                     |
| 23 SMALL HOMES                    | 49 AUTO REPAIR AND FOOD STORE            |
| 24 SCHOOLS                        | 50 GAS STATIONS & CONVENIENCE STORES     |
| 25 THEOLOGICAL CENTER             | 51 EDUCATIONAL CENTER                    |
| 26 GUEST HOUSES                   | 52 NATURE PRESERVES (THRU-OUT)<br>WOODS  |

\* PROPOSED BY:FRANK LLOYD WRIGHT, ARCHITECT(SEE: THE LIVING CITY C. 1958.)

- STREET LIGHTS ARE FROM THE CURB AT GROUND LEVEL, SO THE STARS CAN BE SEEN AT NIGHT, AND CARS DO NOT NEED TO USE HEADLIGHTS.
- POWER & TELEPHONE WIRES ARE BELOW-GROUND OR ENCASED IN STRUCTURES PROVIDED.
- BUILDINGS FIT THEIR NATURAL SITE WITHOUT BULLDOZING; TALL BUILDINGS ARE ISOLATED IN PARKLIKE SETTINGS.

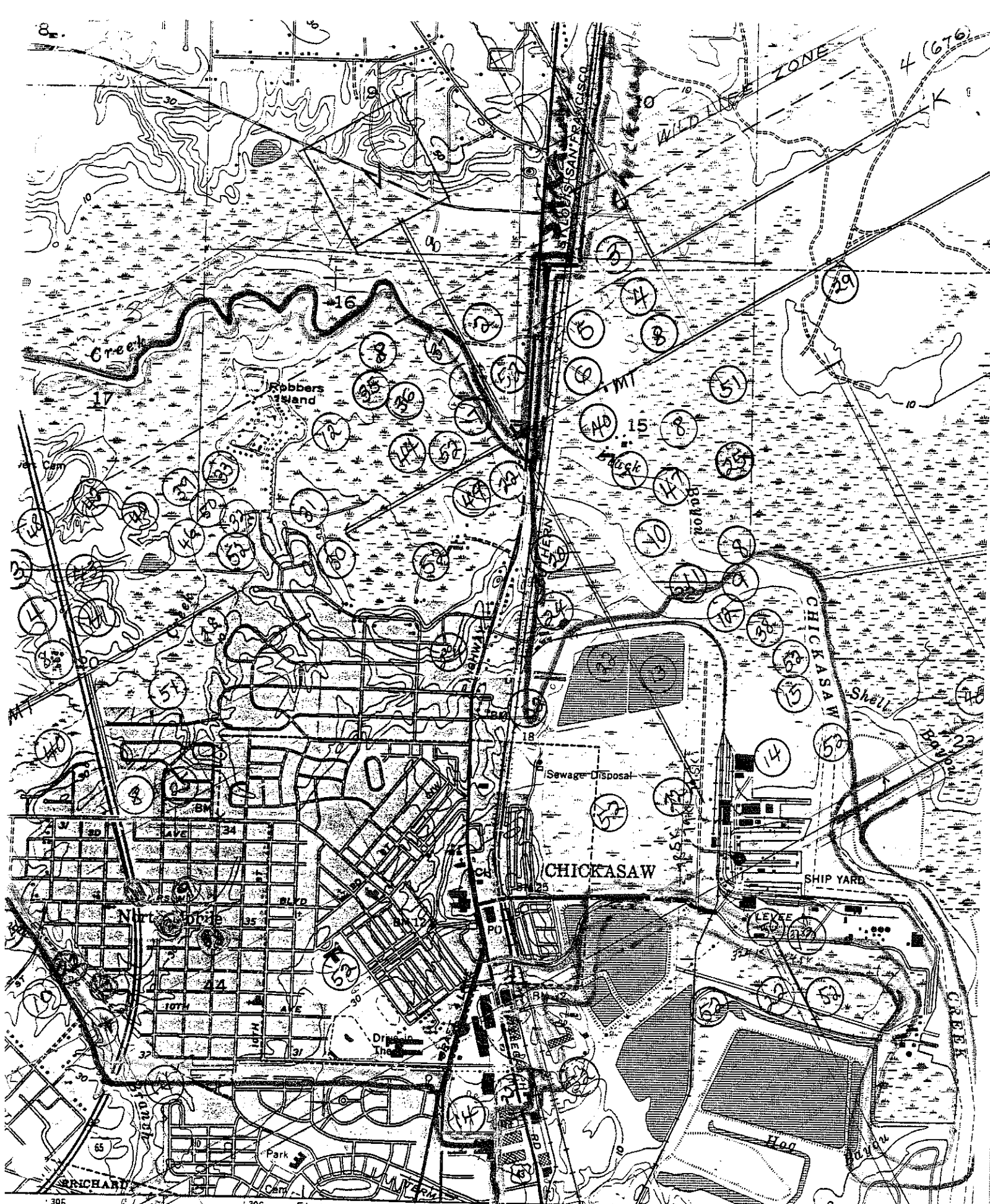

BROADACRES CITY PATTERN

1.4 MI. TO U.S. 31 & 90 (MOBILE)  
MOBILE (P. O.) 4.2 MI. 3345 11 NE

SCALE 1:24000

0° 25' = 16.5' on map  
0° 1' = 6.604' on map

8.16.93

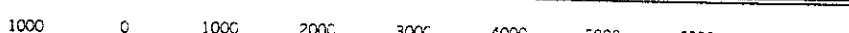

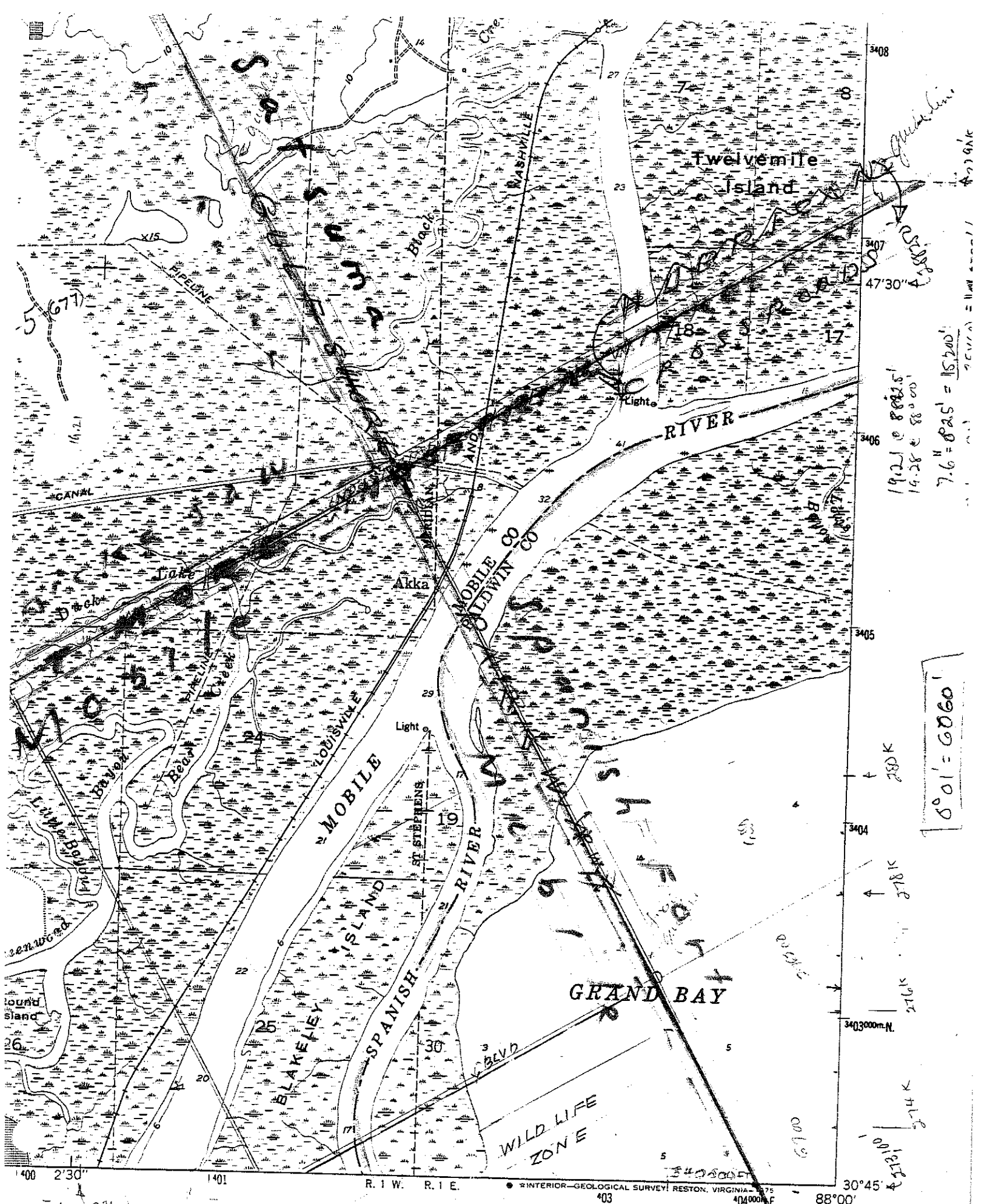

*KYMAK: Site Selection*  
*DOUGLAS BOYO, agent*

*AL 8660/0534*

ROAD CLASSIFICATION

Heavy-duty

Light-duty

0.01' = 0.0060'

1921 @ 8825'  
 14.28 @ 88000'

7.6 @ 825' = 115,200'

3403000m N

30°45'

88°00'

(BRIDGEHEAD 3445 111 NW)

280K

281K

282K

283K

284K

285K

286K

287K

288K

289K

290K

291K

292K

293K

294K

295K

296K

297K

298K

299K

300K

301K

302K

303K

304K

305K

306K

307K

308K

309K

310K

311K

312K

313K

314K

315K

316K

317K

318K

319K

320K

321K

322K

323K

324K

325K

326K

327K

328K

329K

330K

331K

332K

333K

334K

335K

336K

337K

338K

339K

340K

341K

342K

343K

344K

345K

346K

347K

348K

349K

350K

351K

352K

353K

354K

355K

356K

357K

358K

359K

360K

361K

362K

363K

364K

365K

366K

367K

368K

369K

370K

371K

372K

373K

374K

375K

376K

377K

378K

379K

380K

381K

382K

383K

384K

385K

386K

387K

388K

389K

390K

391K

392K

393K

394K

395K

396K

397K

398K

399K

400K

401K

402K

403K

404K

405K

406K

407K

408K

409K

410K

411K

412K

413K

414K

415K

416K

417K

418K

419K

420K

421K

422K

423K

424K

425K

426K

427K

428K

429K

430K

431K

432K

433K

434K

435K

436K

437K

438K

439K

440K

441K

442K

443K

444K

445K

446K

447K

448K

449K

450K

451K

452K

453K

454K

455K

456K

457K

458K

459K

460K

461K

462K

463K

464K

465K

466K

467K

468K

469K

470K

471K

472K

473K

474K

475K

476K

477K

478K

479K

480K

481K

482K

483K

484K

485K

486K

487K

488K

489K

490K

491K

492K

493K

494K

495K

496K

497K

498K

499K

500K

501K

502K

503K

504K

505K

506K

507K

508K

509K

510K

511K

512K

513K

514K

515K

516K

517K

518K

519K

520K

521K

522K

523K

524K

525K

526K

527K

528K

529K

530K

531K

532K

533K

534K

535K

RED BRIDGE  
DATE DUE  
11 03 20 03

MCPL MI  
DATE DUE  
03 28 01

DATE DUE

720.1 W93T  
A TESTAMENT.  
NI MCPL  
AD  
3 0000 00206431 3...

"Still to be discovered as a devoted son of culture is the inspired architect, the public servant who, if appreciated and used, could express the quality of depth and validity in the human values of our society, enabling us to qualify this ruthless imposition of quantity over quality. The artist-architect will be a man inspired by love of the nature of Nature, knowing that man is not made for architecture; architecture is made for man. He will see the practice of architecture never as a business but always religiously as basic to the welfare and culture of humanity as, at its best, it ever has been. And we must recognize the creative architect as poet and interpreter of life. We have only to consider what he has done and where he has been in every true culture of all time to see how important this son of culture is to our own future as a nation. By way of a growing art chiefly comes the culture that fertilizes society, by fructifying the individual and enabling men to call their lives their own. This enrichment of life is the cause of Architecture, as I see it." (pages 191-92)

F R O M A T E S T A M E N T B Y

FRANK  
LOYD  
WRIGHT

IMO Public Library