

key:

Red — New study room
Area = 104m²

Green — Presentation practice room
/ A3 printing
Area = 29m²

Blue — Post graduate deck
Area = 271m²

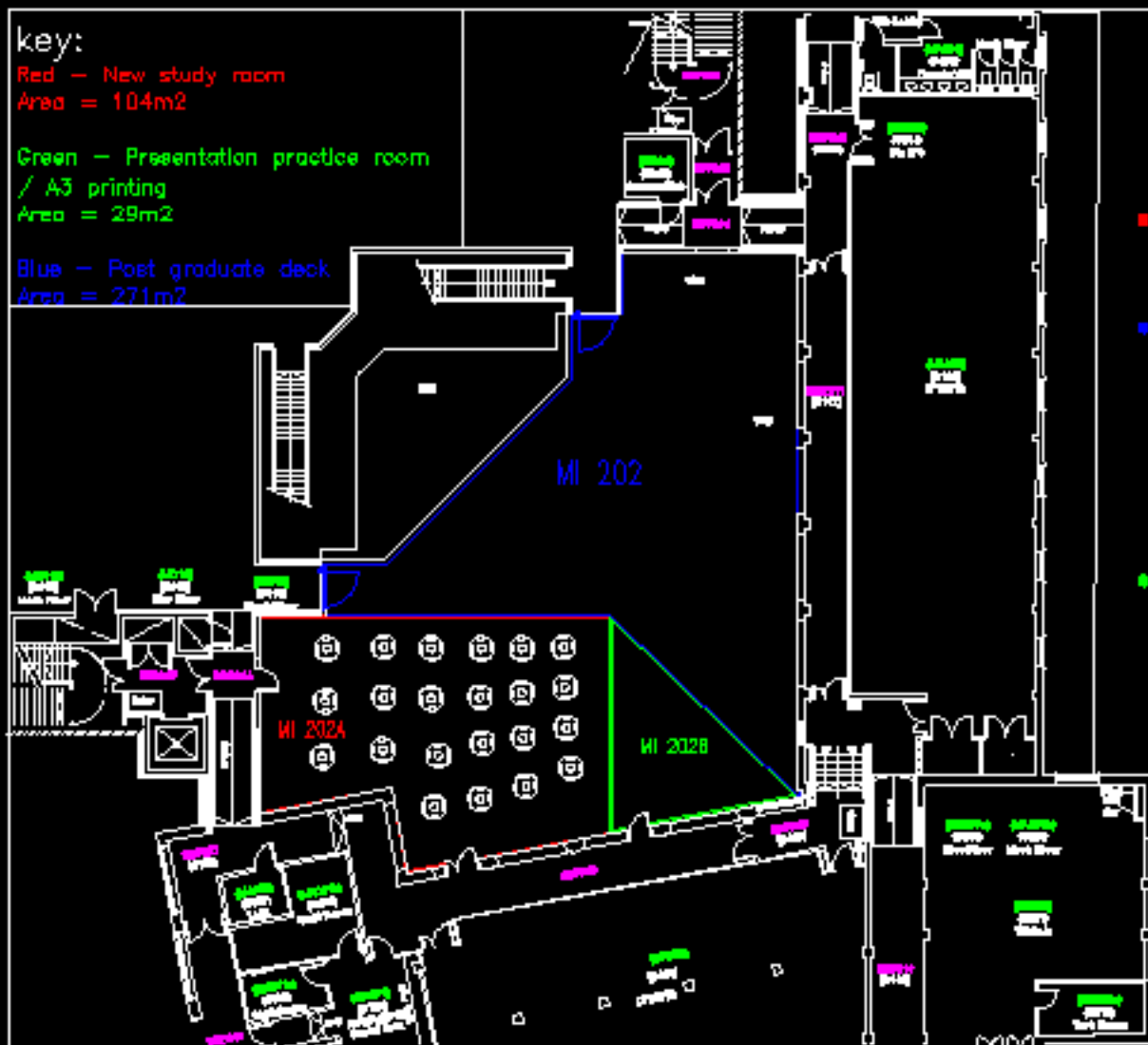

- The new study area should be able to hold a capacity of 60 students.
- The post grad deck original size was 200m², and after development has increased in size by 71m². This increase of space enables more space for post graduate student on the 2nd floor.
- The presentation practice and A3 printing, is identical to the one on the 1st floor.

Name: Solomon Kamanu

Assignment: Semester 2 Assignment 1

Scale: 1:50

Drawing: 2nd floor after redevelopment