



HOW TO USE YOUR SLIDE CARD TOOL For PS2's (FOR VERSIONS 1-11)



Table of Contents

<u>TABLE OF CONTENTS</u>	2
<u>RECOMMENDED TOOLS:</u>	3
<u>BEFORE YOU BEGIN:</u>	3
<u>STEP #1: FRONT COVER REMOVAL</u>	4
<u>STEP #2: USING YOUR SLIDE CARD TOOL</u>	6
<u>PLAYING CD PS2 BACKUPS USING SWAP MAGIC DISCS</u>	10
<u>PLAYING PS1 BACKUPS USING BREAKER PRO DISC</u>	11

RECOMMENDED TOOLS:

#1 PHILLIPS SCREWDRIVER



- 1) #1 Phillips screwdriver

NOTE: Having the right tool for the right job will make all the difference between a pleasant experience vs. a nightmare!!!

BEFORE YOU BEGIN:

Make sure you that you read this guide first before attempting to use the Slide Card tool.

This Kit includes 1 Slide Card tool that is specially designed for PS2 models V1-V11 so that you can use the Breaker Pro and/or the Swap Magic discs on your system, this means you can play backups/imports has you like without having to open your system and loose your system warranty.

Additional/replacement Slide Cards can be purchased at http://www.mod-chip.com/index2.php?go=en/select_ps2.htm

Breaker Pro discs must be purchased separately at http://www.mod-chip.com/index2.php?go=en/select_ps2.htm

NOTE: ALL TEXT IN BLUE IN THIS DOCUMENT ARE URL LINKS FOR YOUR REVIEW!!!

STEP #1: Front Cover Removal

In order for the Slide Card tool to work, you will have to remove the front cover of your DVD/CD drive as shown below in figure #1. **NOTE: you do not have to open your PS2 console so that the DVD/CD tray faceplate can be removed!!!**



FIGURE #1

First plug-in your PS2 console and select the  button so that the DVD tray will be exposed; now you can turn off the power and disconnect the power cord (do not push the DVD tray back-in) and turn over your PS2 console as shown below in figure #2.



FIGURE #2

Now unscrew the flathead screw on the underside of the DVD tray as shown below in figure #3 and figure #4. **NOTE: this screw is not available on the V9 and V10 models; in that case, you need to gently pull off the DVD/CD drive faceplate.**

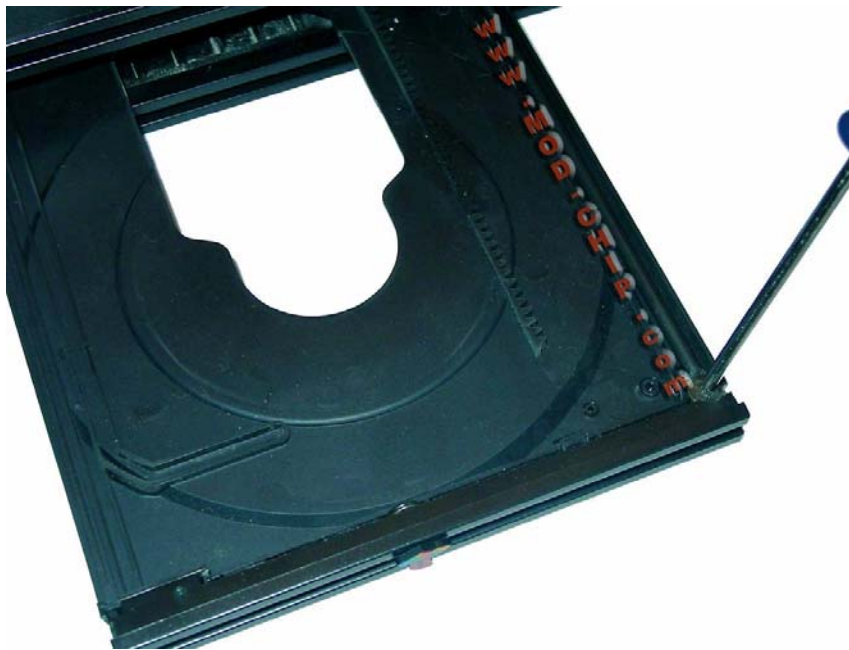

FIGURE #3

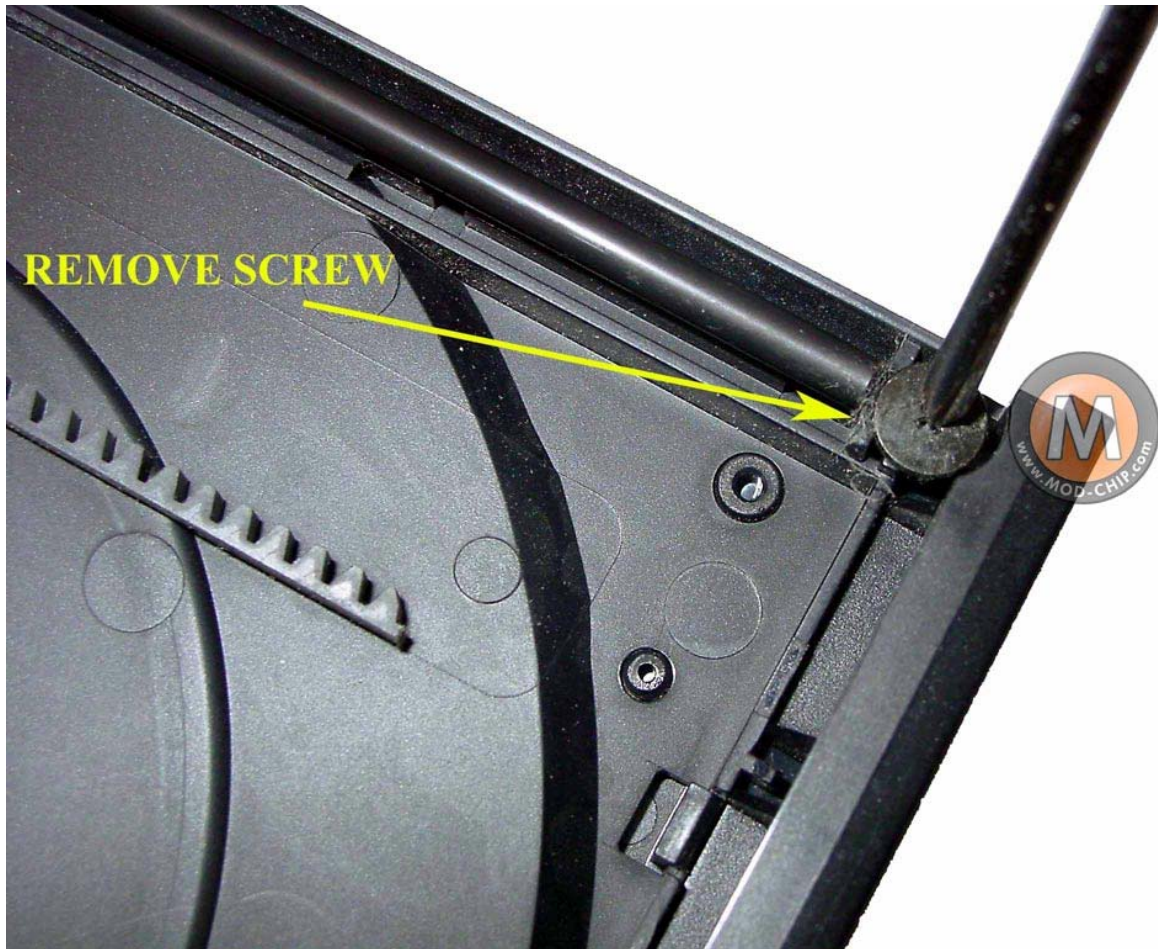



FIGURE #4

For PS2 models V1 – V8, you will notice that the faceplate is clipped on both the right and left side of the DVD/CD tray. Gently bow the faceplate outward on one side a little so that it can clear the holding clip on the one side. Now you can safely remove the faceplate once you have cleared the holding clip on one side. Gently remove the DVD/CD faceplate and replace the flathead screw into the slot from where it was removed (this is so that you do not lose it). **NOTE: be extremely careful to exert too much pressure as you may break/damage plastic components, You can also use a hair dryer to heat the plastic so it is more flexible and is less likely to break!!!**

STEP #2: Using Your Slide Card Tool

Now that you have removed the DVD/CD tray faceplate, you are now ready to use your

Slide tool. Plug-in your PS2 console and turn it on. Next hit the select  button and insert the Swap Magic disc (DVD disc for DVD and CD disc for CD discs) and close the tray. Select the reset button and wait until the following screen appears.

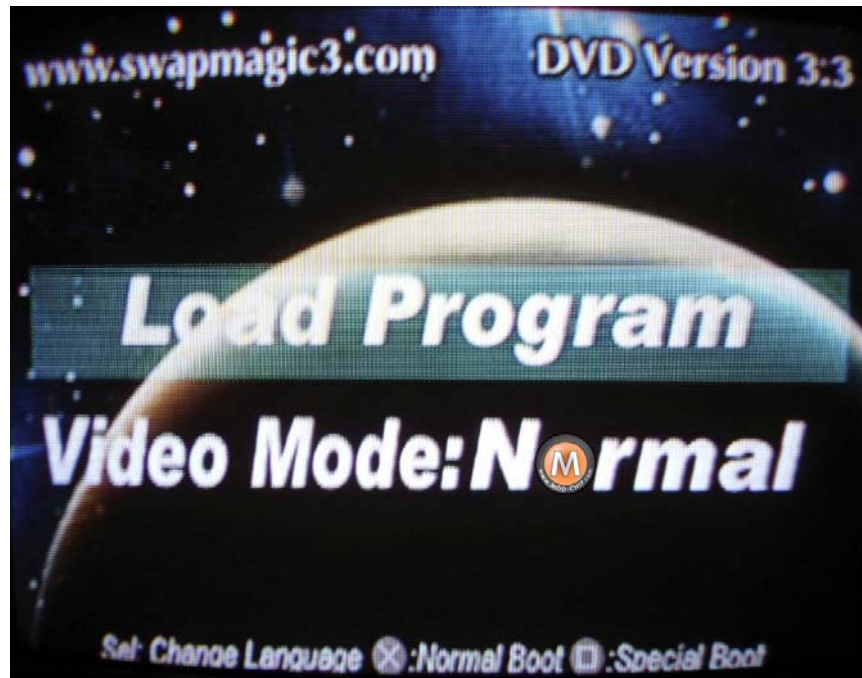

FIGURE #5

Insert the Slide Card tool UNDERNEATH the DVD/CD tray on the left side as shown below in figure #6. **NOTE: it should slide in with no problems.**

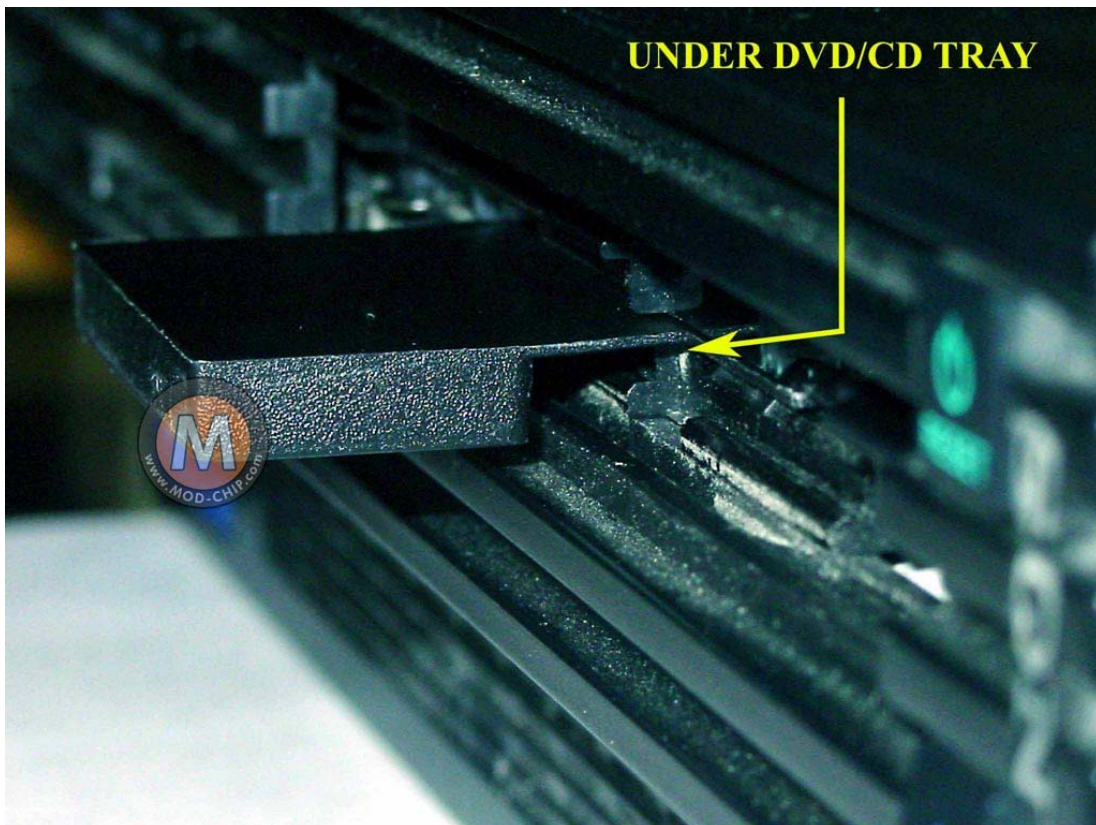

FIGURE #6

Gently slide it to the right while keeping a firm grip.

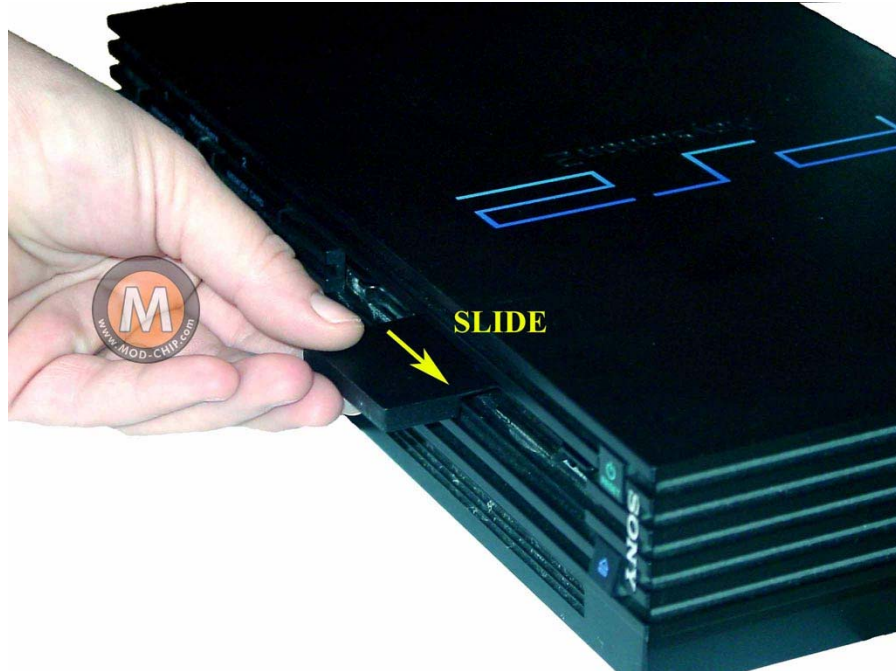

FIGURE #7

You should feel some resistance as the DVD/CD tray begins to open a little automatically as shown below in figure #8. You can now pull the tray open the rest of the way with your hand.

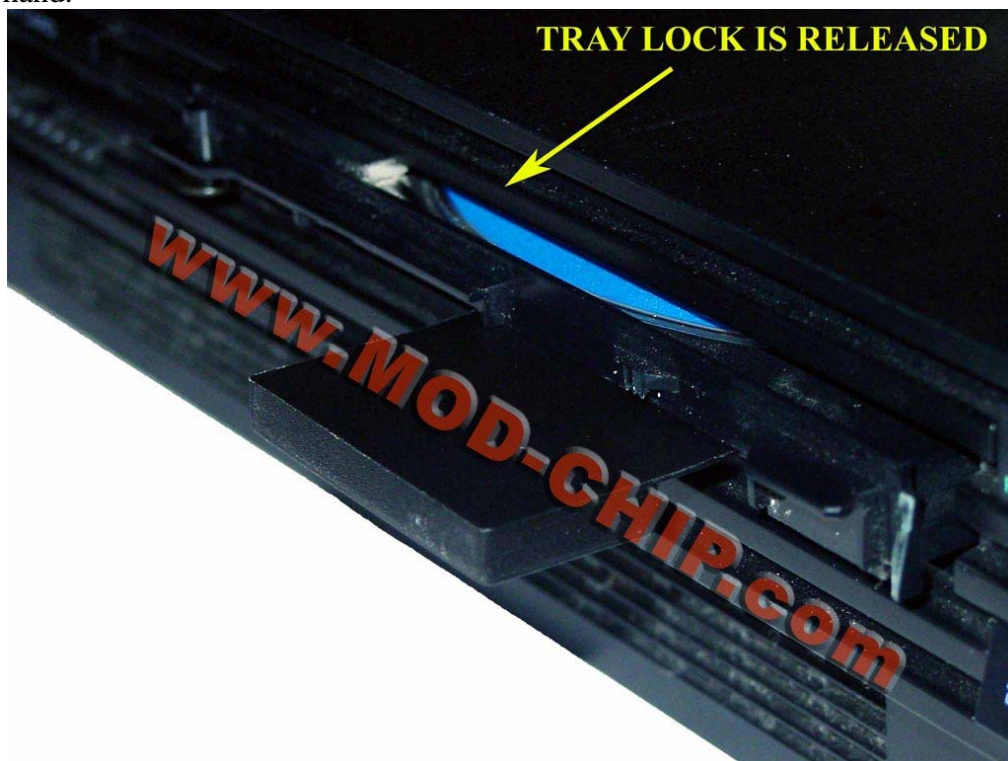

FIGURE #8

Now remove the Swap Magic disc and insert your import/backup disc and close the DVD/CD tray with your hand. **Do not use the eject button or you will have to repeat the swap disc process!!!**



FIGURE #9

Once the tray is closed, you need to lock it back in place so that the PS2 console will begin to read the import/backup game disc. First slide the card to the right as you did before until the tray opens a little automatically. Now release pressure on the Slide Card but continue to slide the card to the right until it moves around a little bump and then it grabs like a hook (see figure #11 for more info). Making sure that the Slide Card has hooked the tab and that it is well inserted; you can now gently slide the card to the left until the DVD/CD tray closes completely. You can now take out the Slide Card.

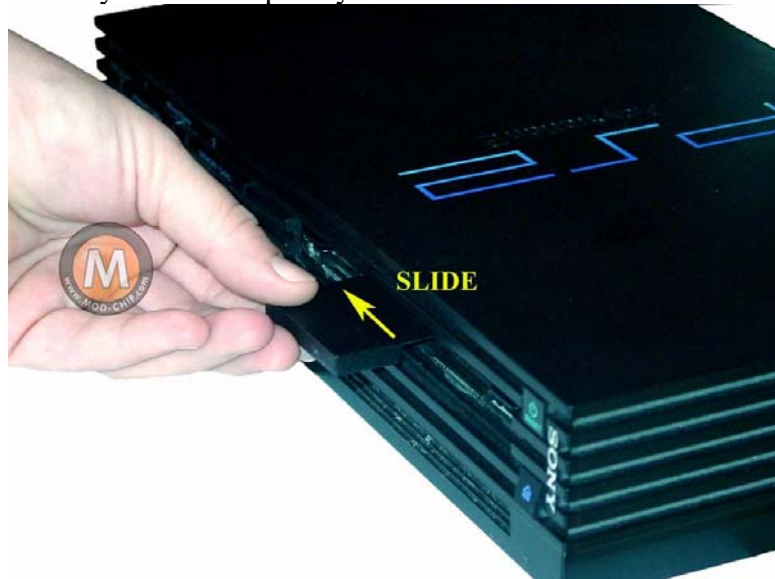

FIGURE #10

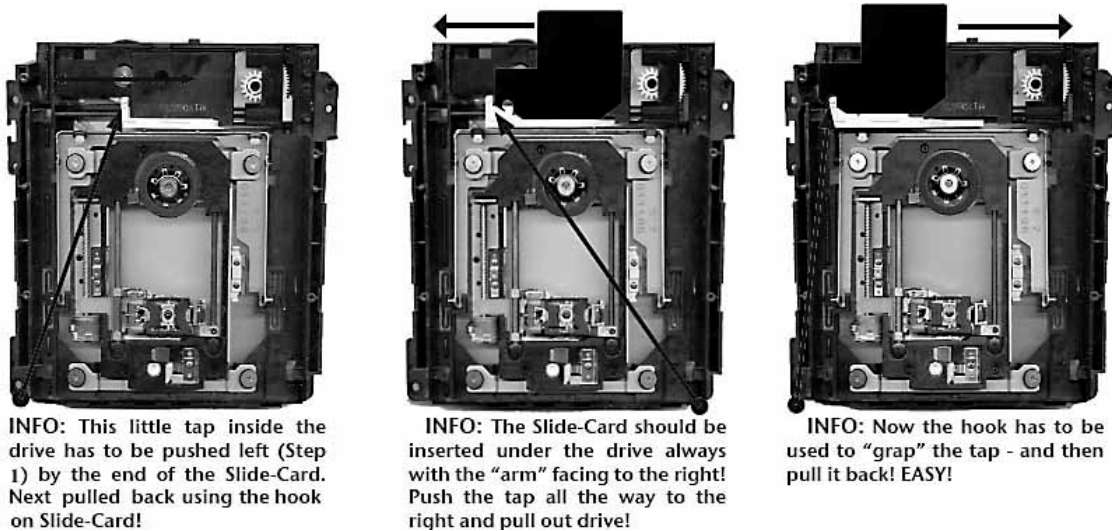

FIGURE #11

You can now press the "X" button on the controller keypad to load your game!!!

Playing CD PS2 Backups using Swap Magic Discs

Open the PS2 DVD tray as described earlier in this manual and load the Swap Magic disc labeled "CD Version" and close the lid. Repeat the steps used for loading a DVD PS2 game disc.

NOTE: Swap Magic Discs DO NOT recognize PS1 games; it only works with PS2 DVD or CD games!!!

You will get the message below (see figure #12) if you inserted a PSX backup game disc or that the inserted disc has read errors.

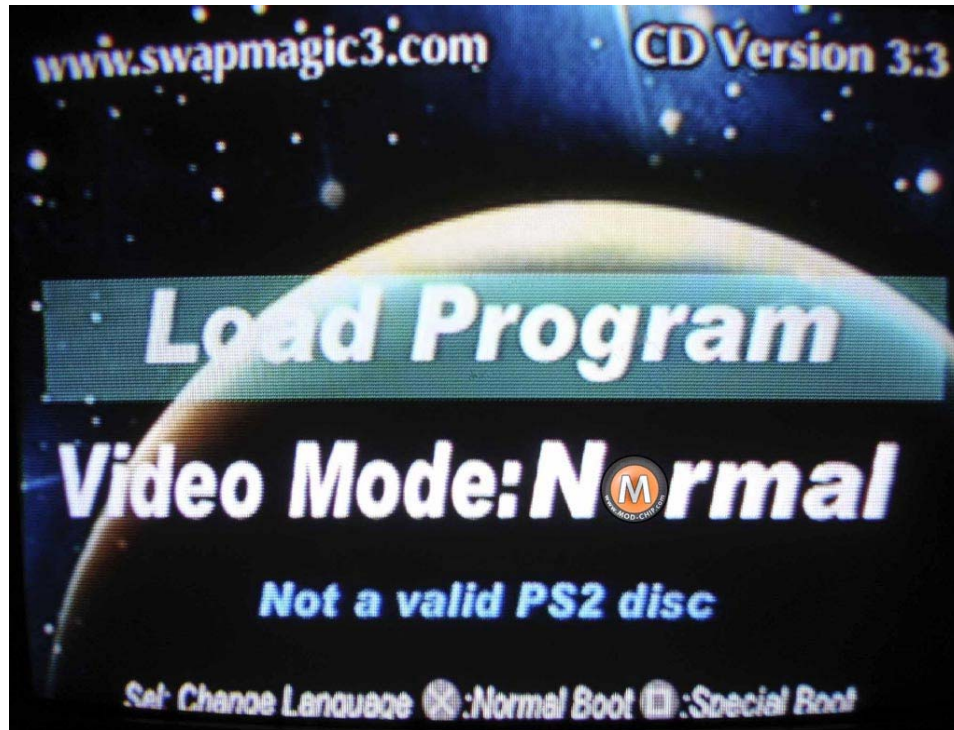

FIGURE #12

Playing PS1 Backups using Breaker Pro Disc

Open the PS2 DVD tray as described earlier in this manual and load the Breaker Pro disc. Select the reset button and wait until the following screen appears.

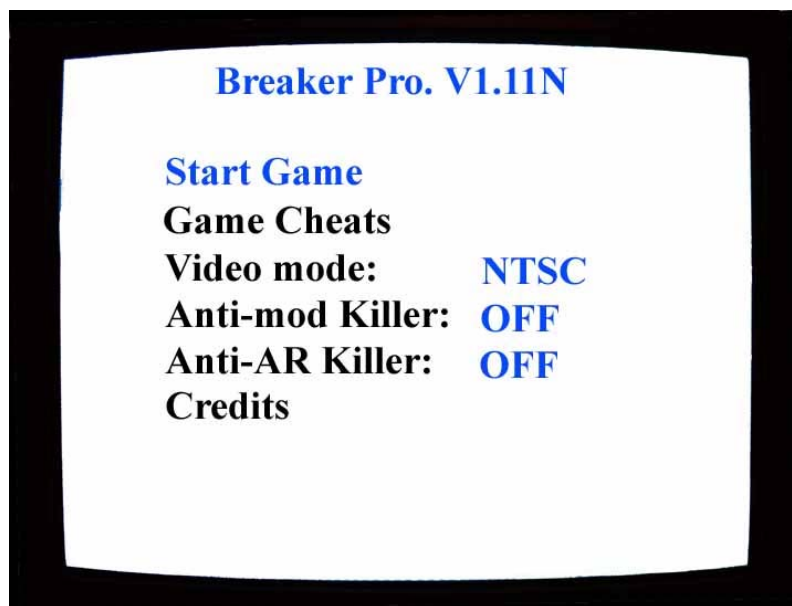

FIGURE #13

Here you can change some of your gaming settings and video mod, once finished, you can then hit the “X” button on the controller #1 keypad to exit this screen. **NOTE: “Game Cheats” is not available on this version of Breaker Pro (Version 1.11).**

Now insert your PS1 game disc into the PS2 DVD tray as described earlier in this manual.

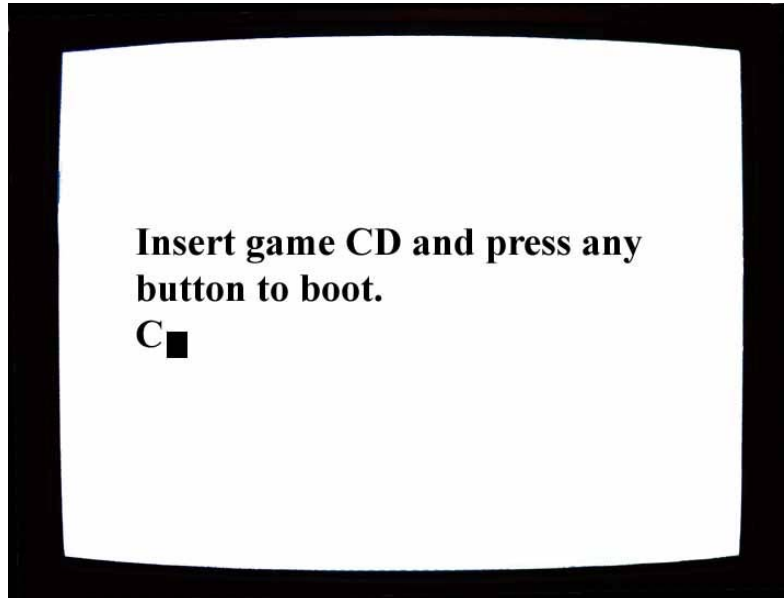

FIGURE #14

Then select the “X” button on the controller #1 keypad to load the PS1 backup game as described earlier in this manual. Your PS1 game should boot as normal.

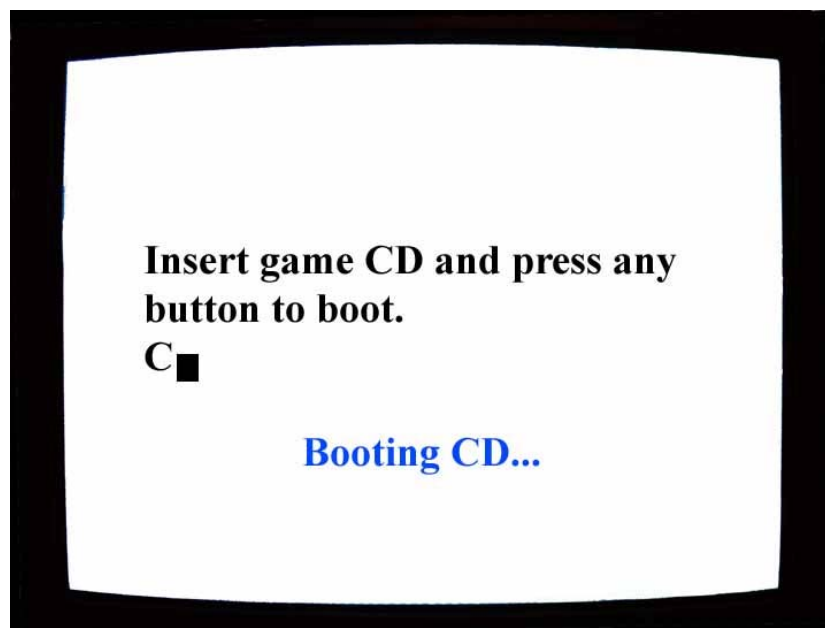

FIGURE #15

NOTE: Breaker Pro works with PS1 game backups only. If a PS2 DVD or CD game is inserted or there is a disc read error, you will continue to see the message in figure #15; no error message will be displayed.

DISCLAIMER: The **SOLE** purpose of the Slide Card, Swap Magic discs or Breaker Pro disc is to enable the original game owner to boot legal original licensed gaming software only. Mod-chip.com **does not condone the illegal copying and/or distribution of copied games and the use of these products to play illegal copied games.** This product is not designed or produced for the purpose of circumventing any technological measures as applied to copyrighted works pursuant to the **Digital Millennium Copyright Act** ("DMCA") section 1201(a)(2). Mod-chip.com distributes this product only to the end user, for personal, authorized use as allowed by law in your respective country. Mod-chip.com only endorses the use of this product for its intended purposes, as allowed in your respective country. You may not, however, distribute, modify, transmit, reuse, re post, or use the content of the manual for public or commercial purposes, including the text and images without written permission from Mod-chip.com.

Slide Card installation guide created by Kurt Camponi Copyright 2005